

May.1.2024 Copyright 2024 HIROSE ELECTRIC CO., LTD. All Rights Reserved.  
In case of consideration for using Automotive equipment / device which demand high reliability, kindly contact our sales window correspondents.

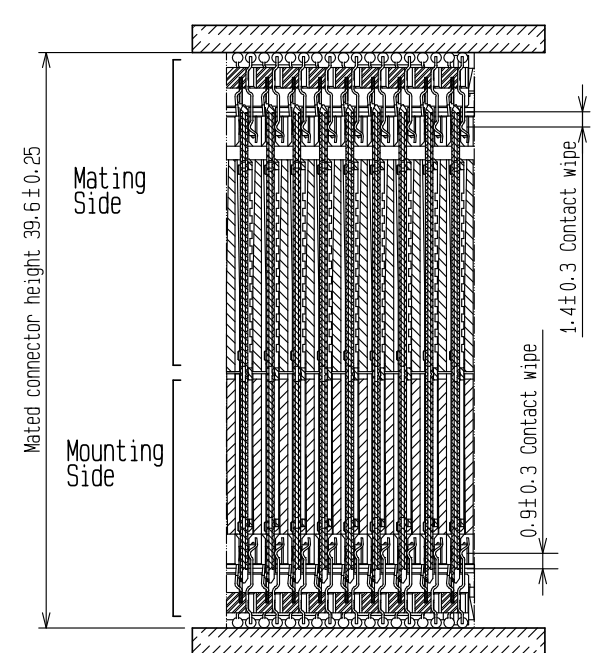
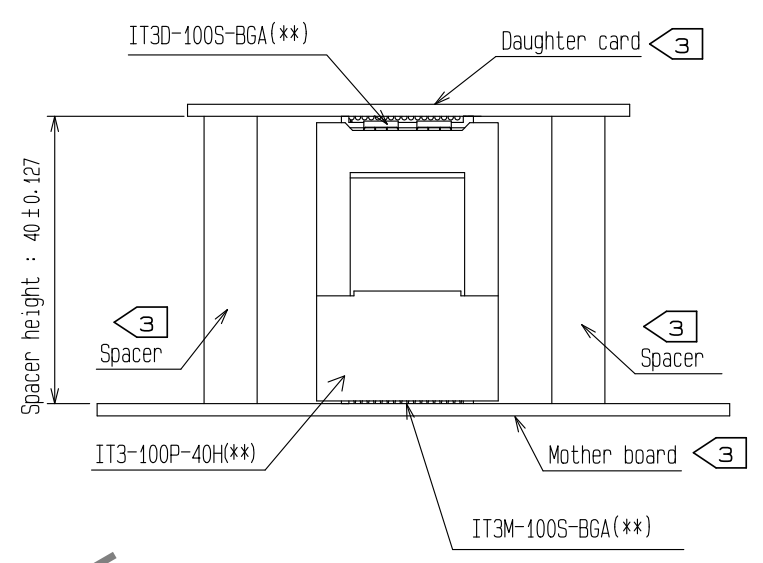
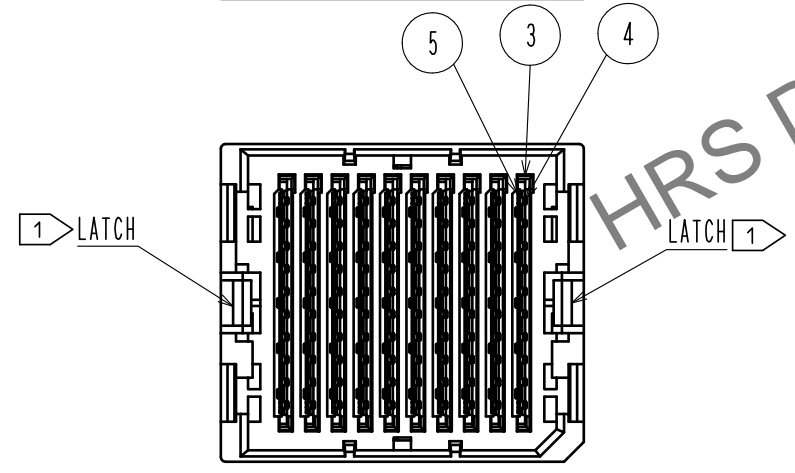
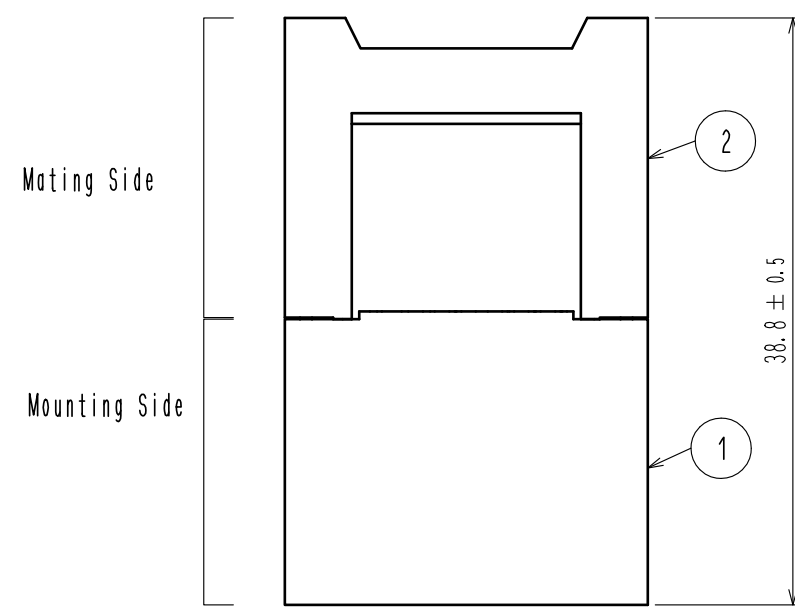
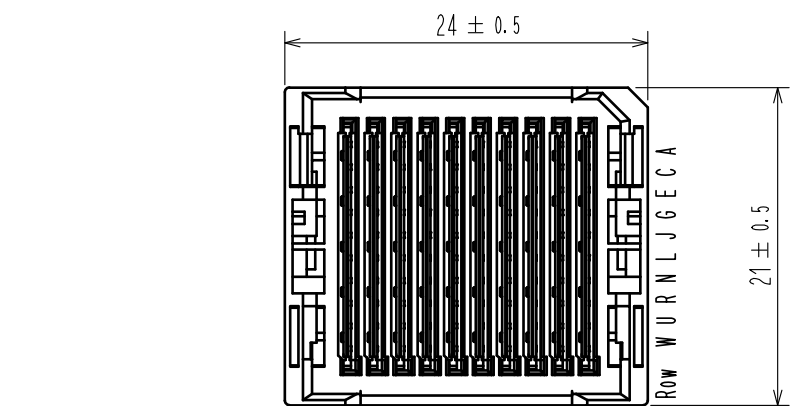

- NOTE.
- 1 Mounting side is mated with the receptacle:IT3M-100S-BGA(\*\*) and fixed with the latch.
  - 2 Lot No. shall be marked on the indicated position.
  - 3 The indicated mother board and daughter card shall be fastened to the additional reinforcements to prevent the stress on IT3\*-100S-BGA(\*\*) solder joints.
  - 4. Please refer to HIROSE document: ETAD-F0347 'IT3 design guideline'.
  - 5. This product consists of 100 signal lines and 90 ground lines.
  - 6. 25pcs of this products are packed in a soft tray.
  - 7. Standard package of 50pcs are packaged in a carton box.

3	LCP	BLACK, UL94V-0	5	Copper Alloy	CONTACT AREA:NICKEL(1.5μm)+GOLD(0.76μm)
2	PBT	GRAY, UL94V-0	4	Copper Alloy	CONTACT AREA:NICKEL(1.5μm)+GOLD(0.76μm)
1	PBT	BLACK, UL94V-0			
NO.	MATERIAL	FINISH , REMARKS	NO.	MATERIAL	FINISH , REMARKS
UNITS mm		SCALE 2 : 1	COUNT 	DESCRIPTION OF REVISIONS	DESIGNED
HIROSE ELECTRIC CO., LTD.		APPROVED : TM. MATSUO	17.05.11	DRAWING NO.	EDC-328491-03-00
		CHECKED : MK. EZAKI	17.05.11	PART NO.	IT3-100P-40H(C03)
		DESIGNED : KT. AIZAWA	17.05.11	CODE NO.	CL636-0230-0-03
		DRAWN : KT. AIZAWA	17.05.11		
					DATE