

Apr.1.2024 Copyright 2024 HIROSE ELECTRIC CO., LTD. All Rights Reserved.
 In case of consideration for using Automotive equipment / device which demand high reliability, kindly contact our sales window correspondents.

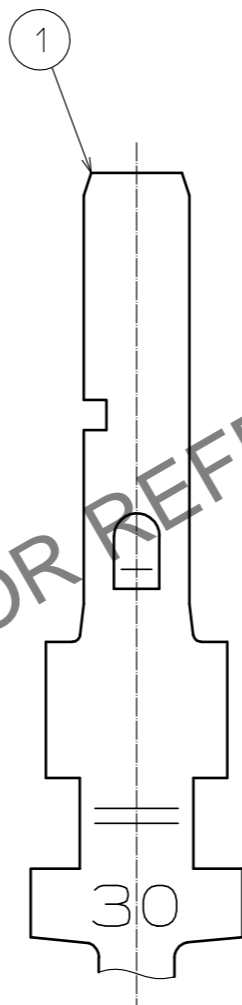
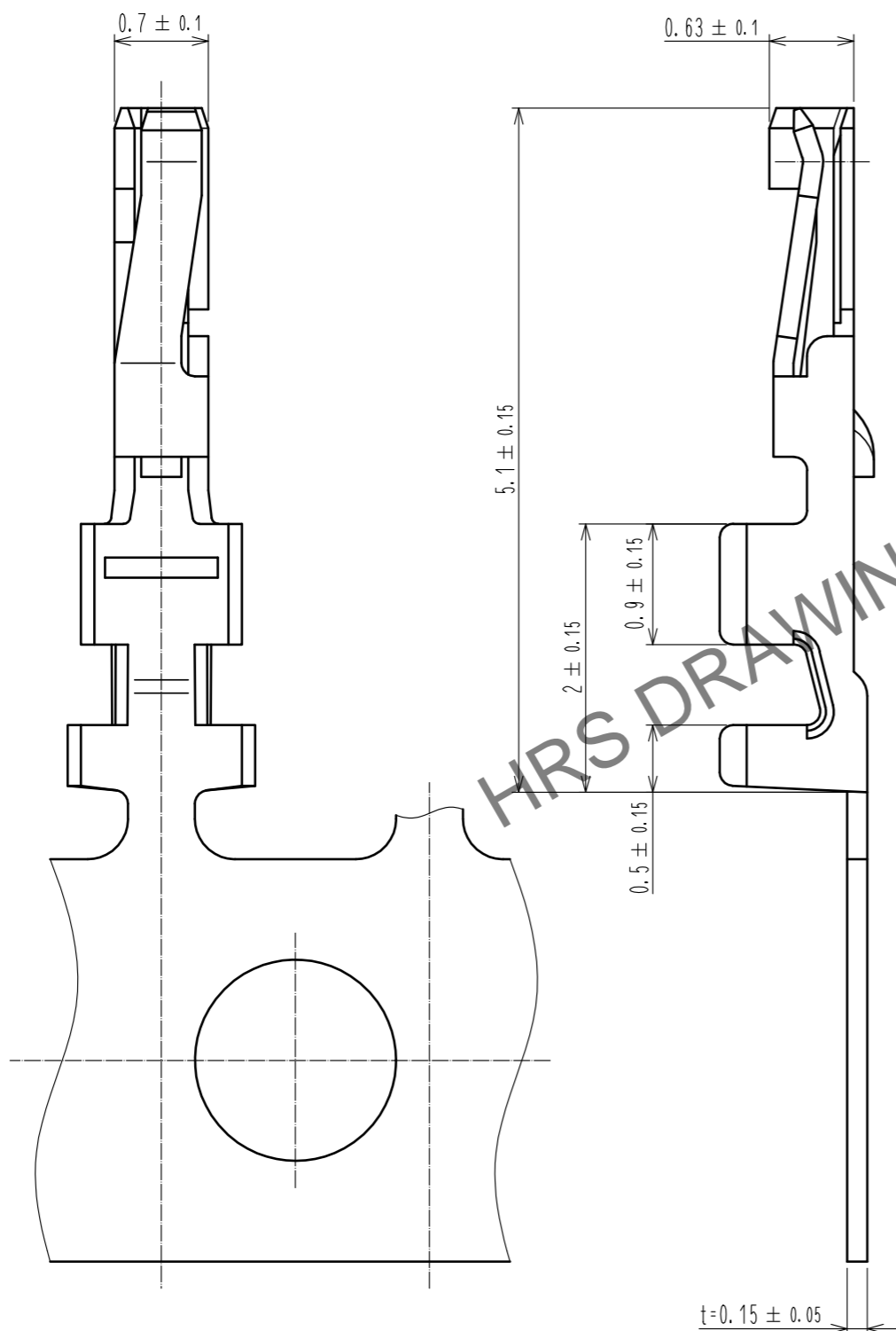
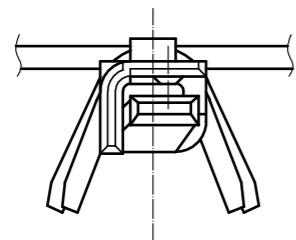

Note 1. Per Reel : 20000 Contacts.

NO.	MATERIAL	FINISH . REMARKS	NO.	MATERIAL	FINISH . REMARKS
1	Phosphor Bronze	Contact Area:Gold Plated 0.2μm MIN Outside of Barrel:Tin Plated 1μm MIN Others:Nickel Plated 0.5μm MIN			

UNITS	SCALE	COUNT	DESCRIPTION OF REVISIONS	DESIGNED	CHECKED	DATE
mm	20 : 1	△				
HRS HIROSE ELECTRIC CO., LTD.			APPROVED : SJ. OKAMURA 20210712 CHECKED : SZ. ONO 20210712 DESIGNED : SS. YAMASAKI 20210712 DRAWN : NK. OOSHIMA 20210707	DRAWING NO. EDC-164752-41-01 PART NO. DF19A-3032SCFA(41) CODE NO. CL0685-0046-0-41	1/1	