

Jul.1.2024 Copyright 2024 HIROSE ELECTRIC CO., LTD. All Rights Reserved.  
 In case of consideration for using Automotive equipment / device which demand high reliability, kindly contact our sales window correspondents.

ELV, RoHS COMPLIANT

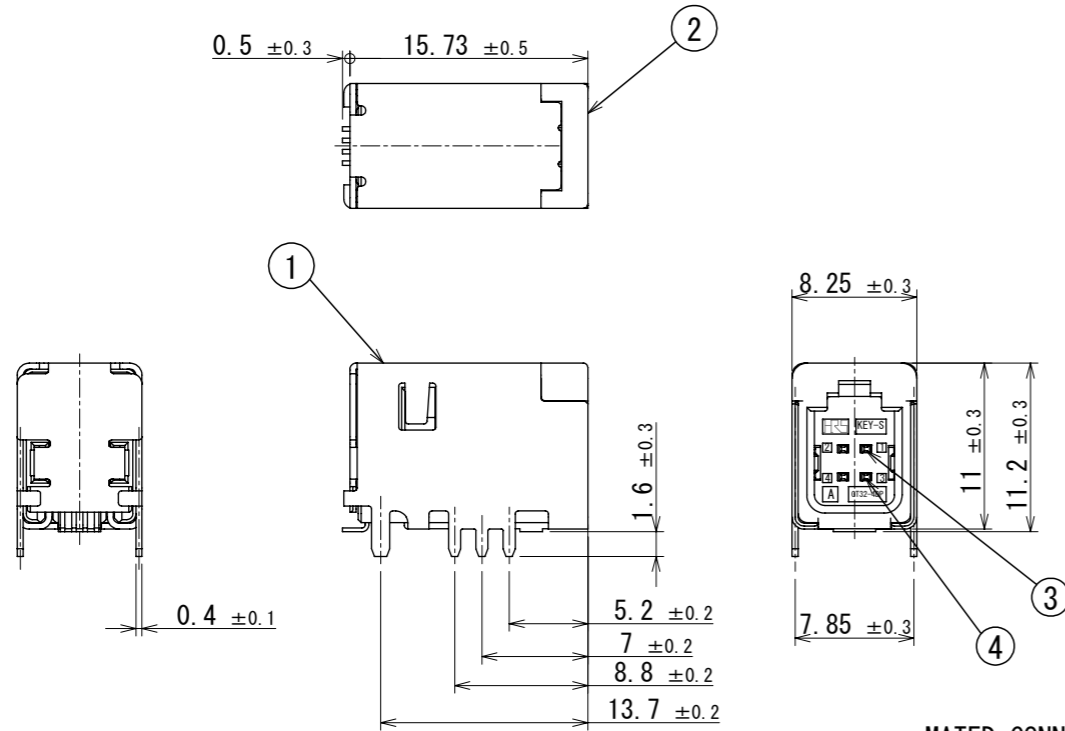

MATED CONNECTORS

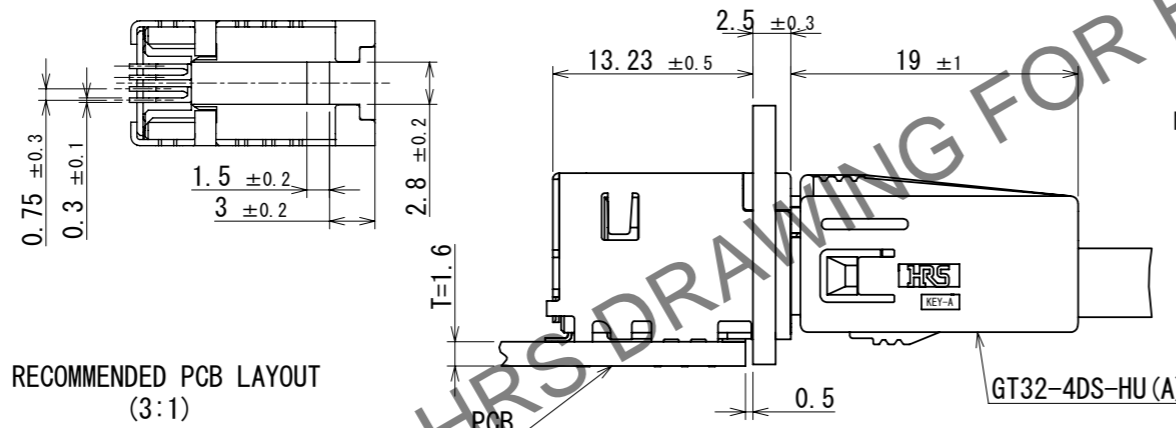

RECOMMENDED PCB LAYOUT (3:1)

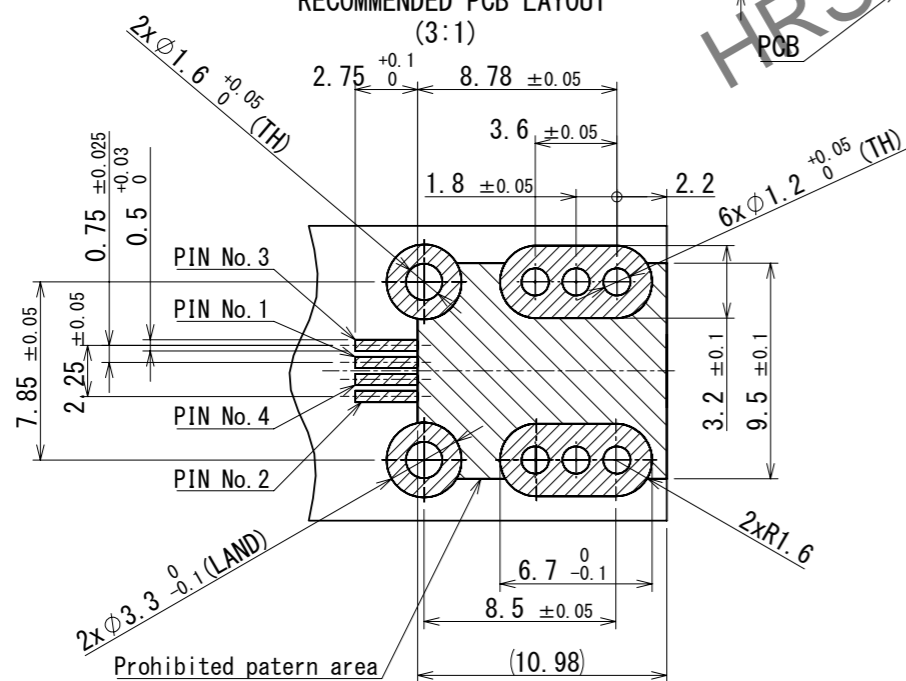

RECOMMENDED PANEL CUTOUT

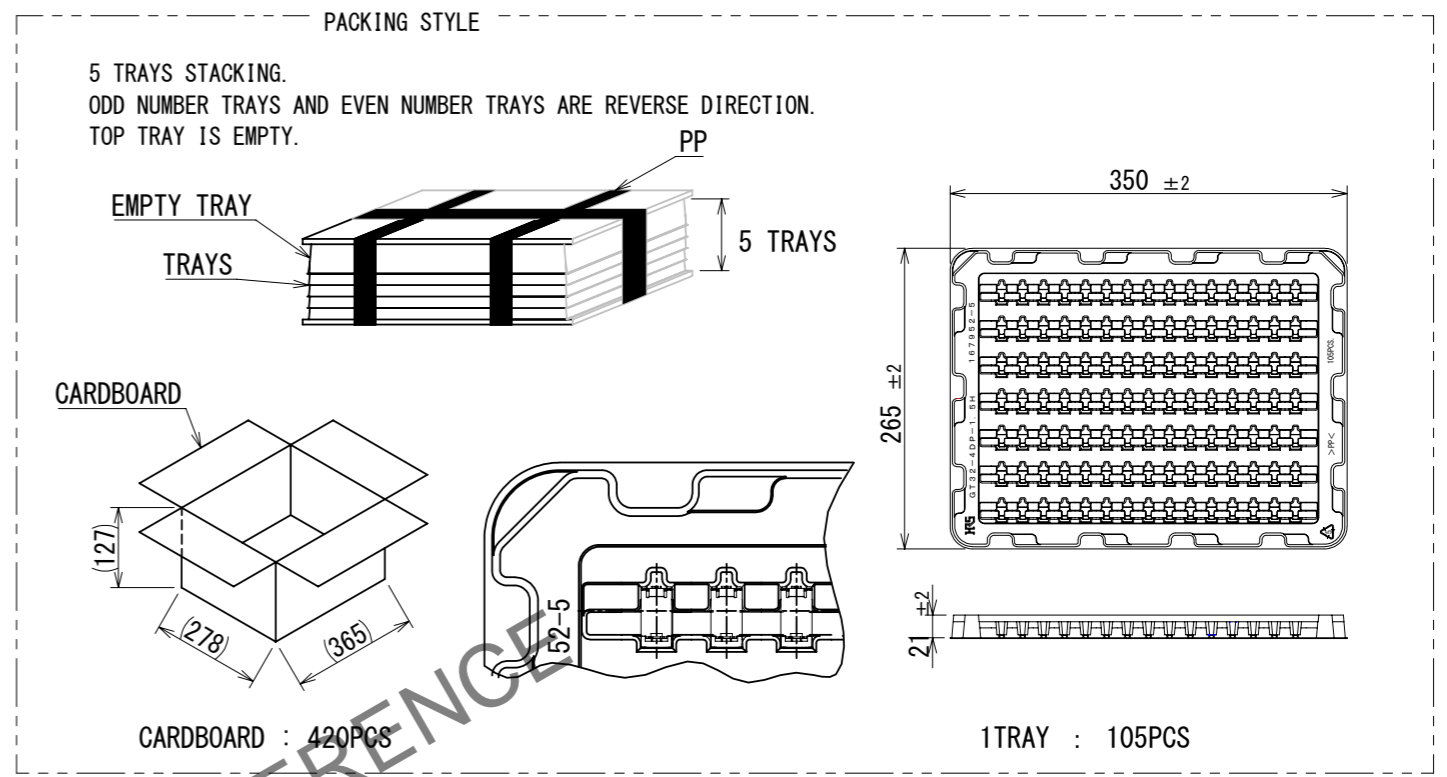
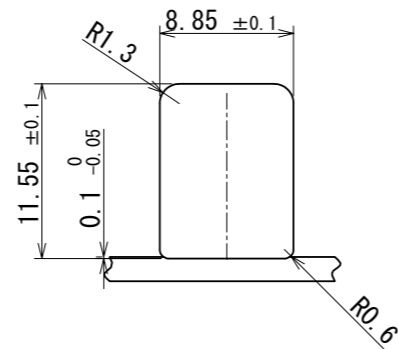

NOTES

1. RECOMMENDED REFLOW PROFILE (SEE RIGHT GRAPH)  
 CYCLE TIME: UP TO 2 CYCLES OF REFLOW SOLDERING ARE POSSIBLE UNDER THE CONDITIONS, PROVIDED THAT THERE IS A RETURN TO NORMAL TEMPERATURE BETWEEN THE FIRST AND SECOND CYCLE.  
 PEAK TEMPERATURE: 250°C  
 230°C MIN, FOR 20 TO 40 SECONDS.  
 PREHEATING AREA 150~180°C FOR 60 TO 120 SECONDS.
2. HAND SOLDERING: 280~300°C, 2SECONDS MAX.
3. CONTACT COPLANARITY: 0.1mm MAX.
4. RECOMMENDED THICKNESS OF PCB: 1.6mm
5. RECOMMENDED THICKNESS OF SOLDERING PASTE: 0.12mm

TEMP. (°C)

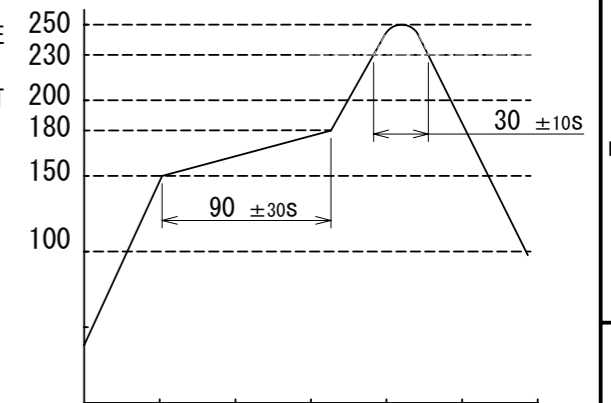

TIME (s)

2	PA	BROWN	4	BRASS	TIN PLATING				
1	COPPER ALLOY	TIN PLATING	3	BRASS	TIN PLATING				
NO.	MATERIAL	FINISH	REMARKS	NO.	MATERIAL	FINISH	REMARKS		
UNITS	mm	SCALE	2:1	COUNT	0	DESCRIPTION OF REVISIONS	DESIGNED	CHECKED	DATE
				DIS-T-00018433		KN. YANAGIMOTO	EJ. WAKATSUKI	2023.06.21	
APPROVED : NH. NAKATA 2015.08.21						DRAWING NO. EDC-361827-10-01			
CHECKED : KI. HIROKAWA 2015.08.21						PART NO. GT32-4DP-1.5H(A) (10)			
DESIGNED : TS. KUBOTA 2015.08.21						CODE NO. CL0782-0061-3-10			
DRAWN : TS. KUBOTA 2015.08.21									