

Jul.1.2024 Copyright 2024 HIROSE ELECTRIC CO., LTD. All Rights Reserved.
 In case of consideration for using Automotive equipment / device which demand high reliability, kindly contact our sales window correspondents.

RoHS, ELV COMPLIANT

PACKING STYLE

5 TRAYS STACKING.
 STACK TRAY A(168146-4) AND TRAY B(168176-0) STAGGERED.
 TOP TRAY IS EMPTY.

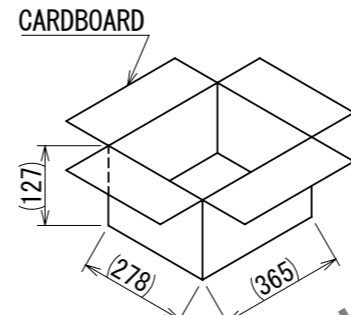
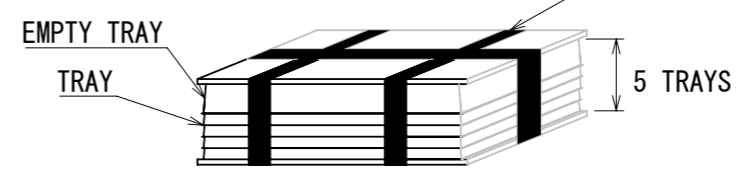

CARDBOARD : 420PCS

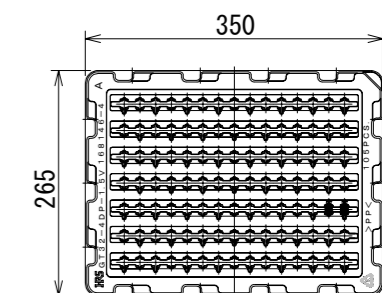
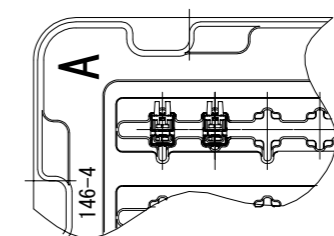

1TRAY : 105PCS

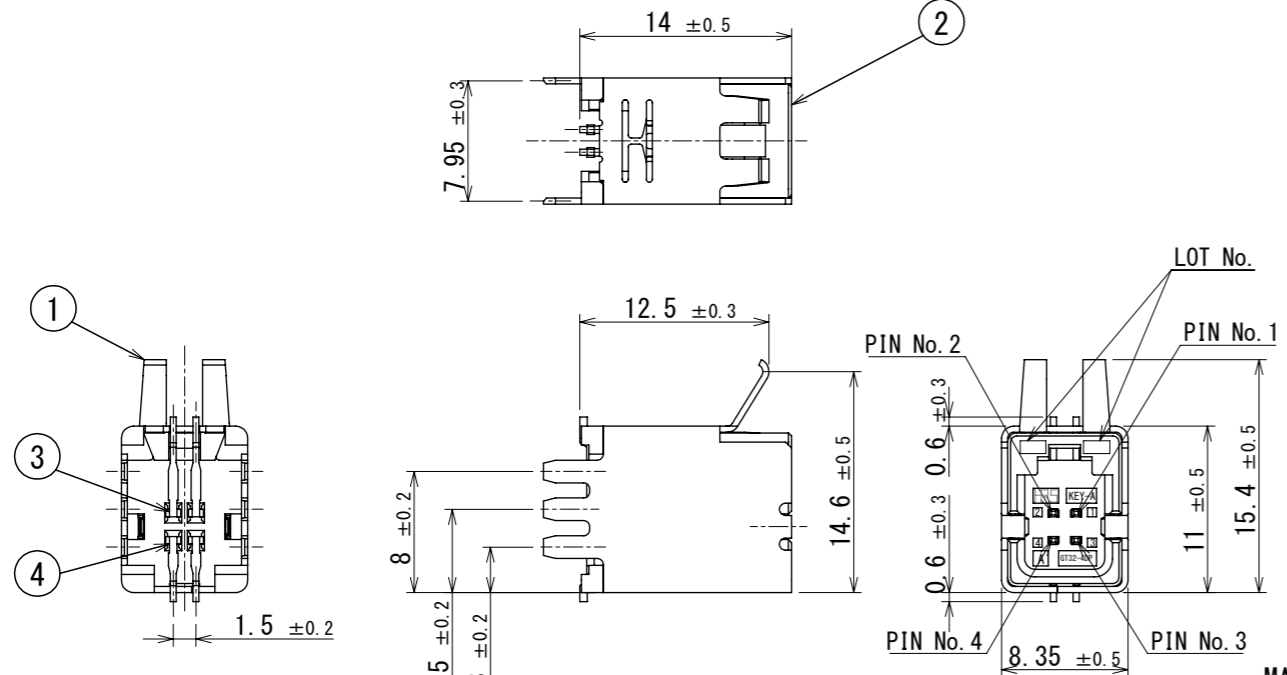

MATED CONNECTORS

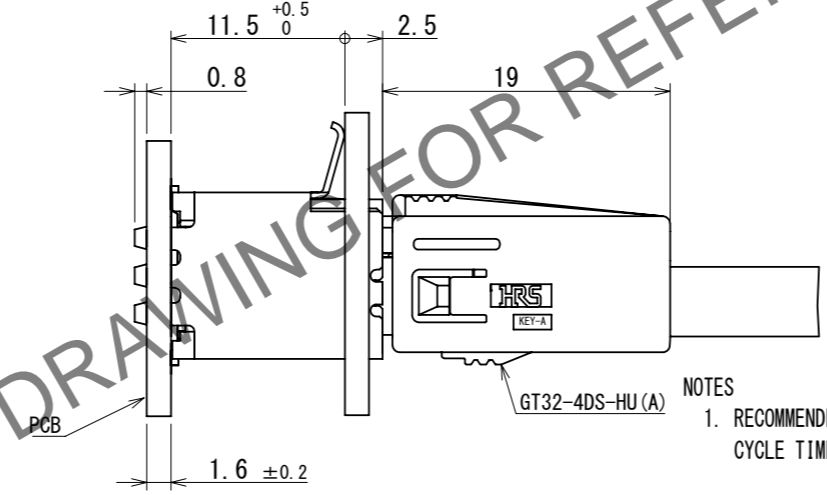
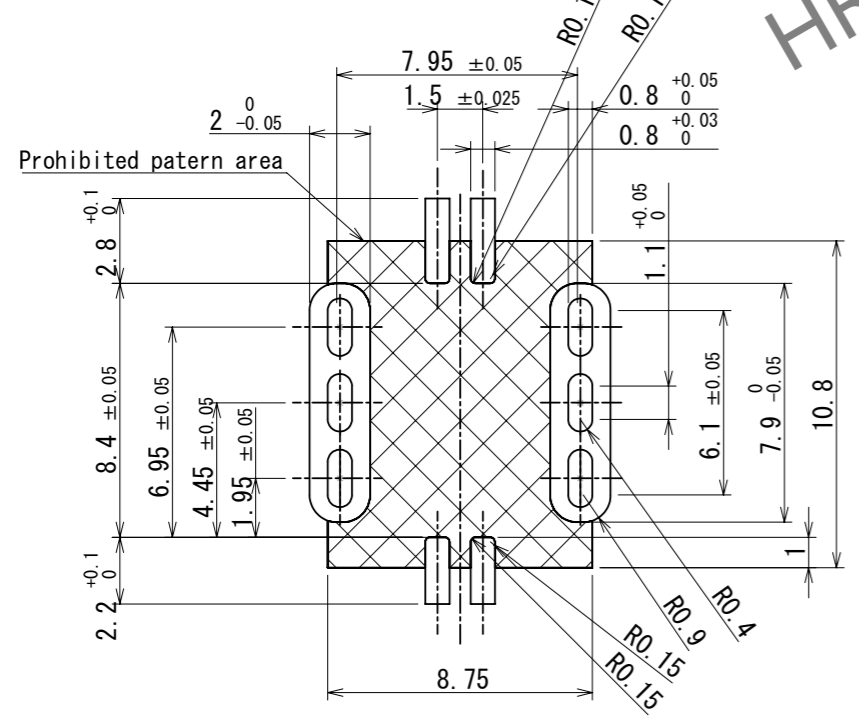

Fig. ADDED A PICK & PLACE TAPE



RECOMMENDED PCB LAYOUT (4:1)



RECOMMENDED PANEL CUTOUT

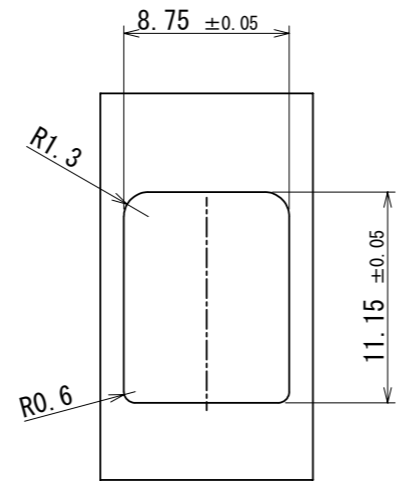

- NOTES
1. RECOMMENDED REFLOW PROFILE (SEE RIGHT GRAPH)
 CYCLE TIME: UP TO 2 CYCLES OF REFLOW SOLDERING ARE POSSIBLE UNDER THE CONDITIONS, PROVIDED THAT THERE IS A RETURN TO NORMAL TEMPERATURE BETWEEN THE FIRST AND SECOND CYCLE.
 PEAK TEMPERATURE: 250°C
 230°C MIN. FOR 20 TO 40 SECONDS.
 PREHEATING AREA 150~180°C FOR 60 TO 120 SECONDS.
 2. HAND SOLDERING: 280~300°C, 2SECONDS MAX.
 3. CONTACT COPLANARITY: 0.1mm MAX.
 4. RECOMMENDED THICKNESS OF PCB: 1.6mm
 5. RECOMMENDED THICKNESS OF SOLDERING PASTE: 0.12mm

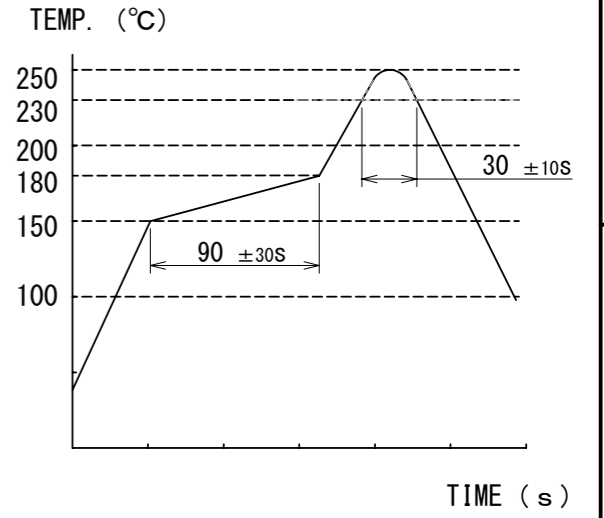

3	BRASS	TIN PLATING						
2	PA	BROWN	5	POLYIMIDE	PICK & PLACE TAPE			
1	COPPER ALLOY	TIN PLATING	4	BRASS	TIN PLATING			
NO.	MATERIAL	FINISH	REMARKS	NO.	MATERIAL	FINISH	REMARKS	
UNITS		SCALE	COUNT	DESCRIPTION OF REVISIONS		DESIGNED	CHECKED	DATE
mm		2:1	0	DIS-T-00018480		KN. YANAGIMOTO	EJ. WAKATSUKI	2023. 07. 03
APPROVED : AR. SHIRAI			2017. 07. 19	DRAWING NO.		EDC-362123-00-00		
CHECKED : TH. MIZUGUCHI			2017. 07. 19	PART NO.		GT32-4DP-1. 5V (A)		
DESIGNED : TS. KUBOTA			2017. 07. 19	CODE NO.		CL0782-0065-4-00		
DRAWN : TS. KUBOTA			2017. 07. 19					