



Space-Saving



Low Profile



RF

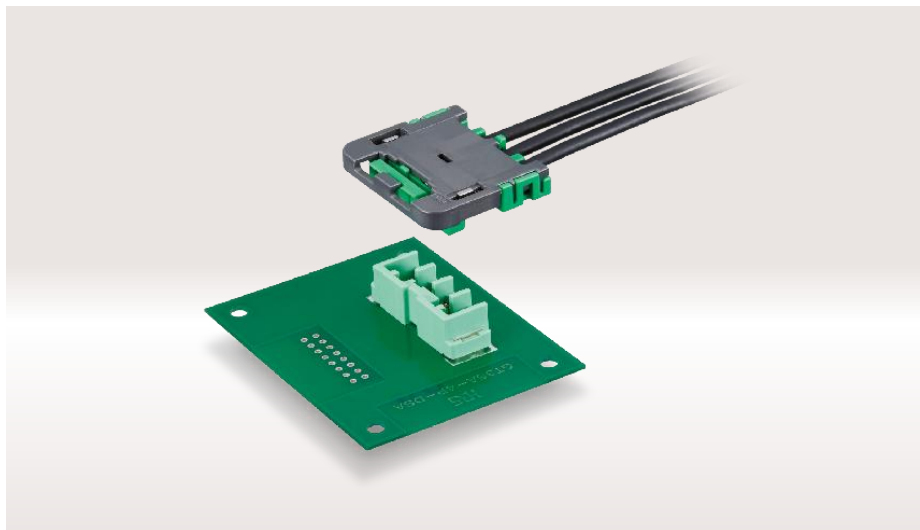

Features

- 1 Small and low-profile design (12mm height)
- 2 Excellent high frequency characteristic for ETC* frequency
- 3 Wide key and pin count varieties
- 4 Through hole reflow

*Electric Toll Collection system

Dimensions

Receptacle

GT36A-4P-DSA

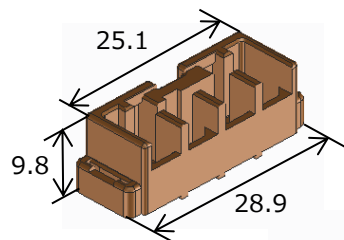

Plug

Housing: GT36A-4S-HU
Cover : GT36A-4S-CV

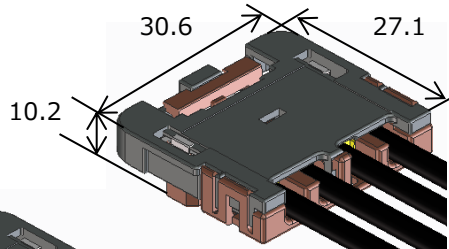

Mated

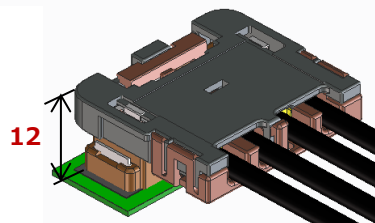

Excellent Contact Design for ETC* Frequency Range (5.9GHz)

【Contact for GPS, Mobile, Bluetooth】
Up to 2.5GHz V.S.W.R. 1.5 Max.

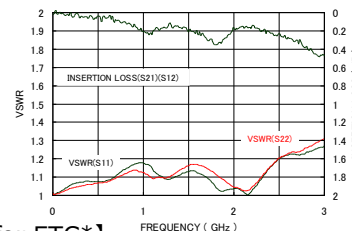

【Contact for ETC*】
Up to 5.9GHz V.S.W.R. 1.5 Max.

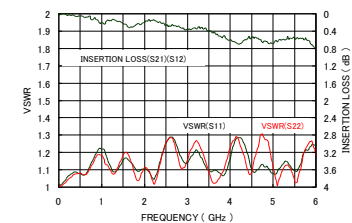

Specifications

Rated Current	1A
Rated Voltage	50V DC
Operating Temperature	-40 to +105 °C*
Contact Resistance	50mΩ Max. (1A DC)
Withstanding Voltage	125V AC for 1 min.
Insulation Resistance	100MΩ Min. (500V DC)
Mating Durability	30 times
V.S.W.R.	1.5 Max. (Up to 5.9GHz) *Measured with GT36G

*Includes the temperature rise by current flow.