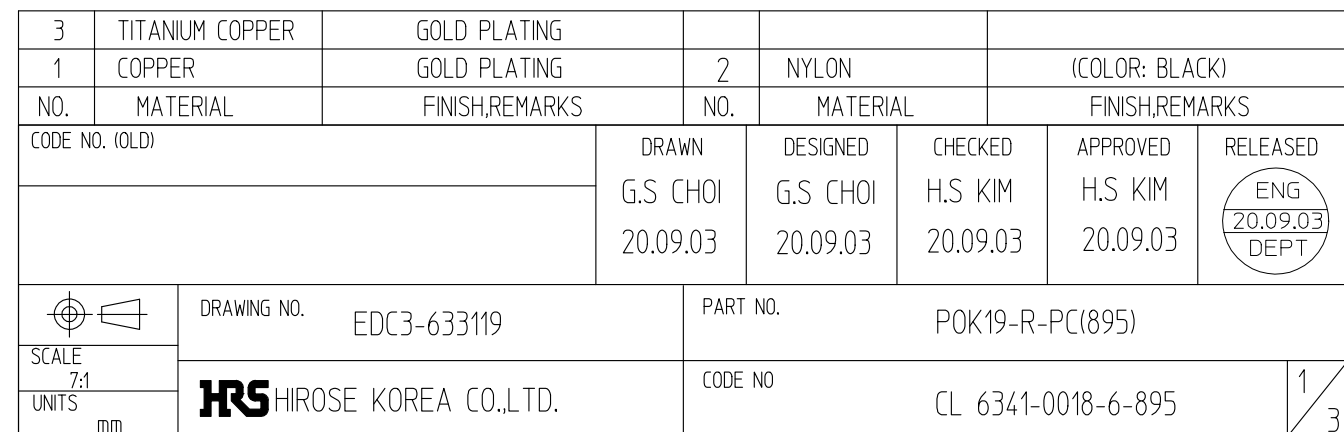

F

Jun.1.2024 Copyright 2024 HIROSE ELECTRIC CO., LTD. All Rights Reserved.
In case of consideration for using Automotive equipment / device which demand high reliability, kindly contact our sales window correspondents.

※Handling notice

1. POK19-PR-PC

- ① Note the contact deformation of 'POK19-PR-PC' due to external objects.
When contact is deformed and 'POK19-R-PC' is combined by contact deformation
It can be a cause lose of function /not be combined/product damage
(Including counterparties).

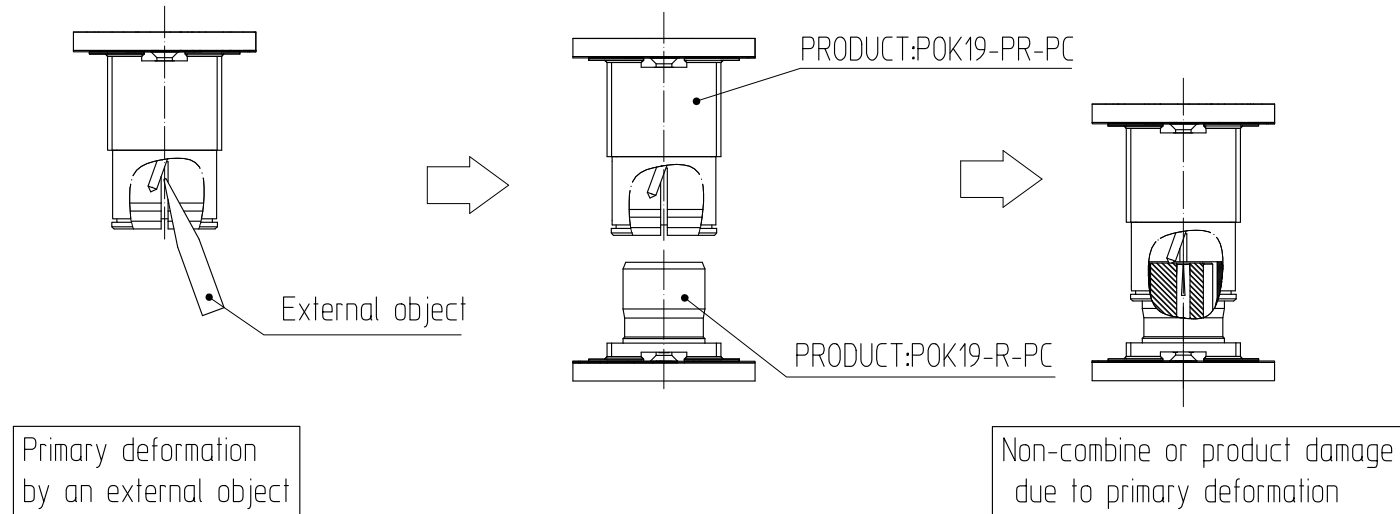

- ② When 'POK19-PR-PC' and 'POK19-R-PC' combine, there shall be no rotation.
If the rotation of 'POK19-PR-PC' or 'POK19-R-PC' occurs in the process of coupling,
contact is deformed. Contact deformation can be a cause lose of function/
not be combined/product damage (Including counterparties).

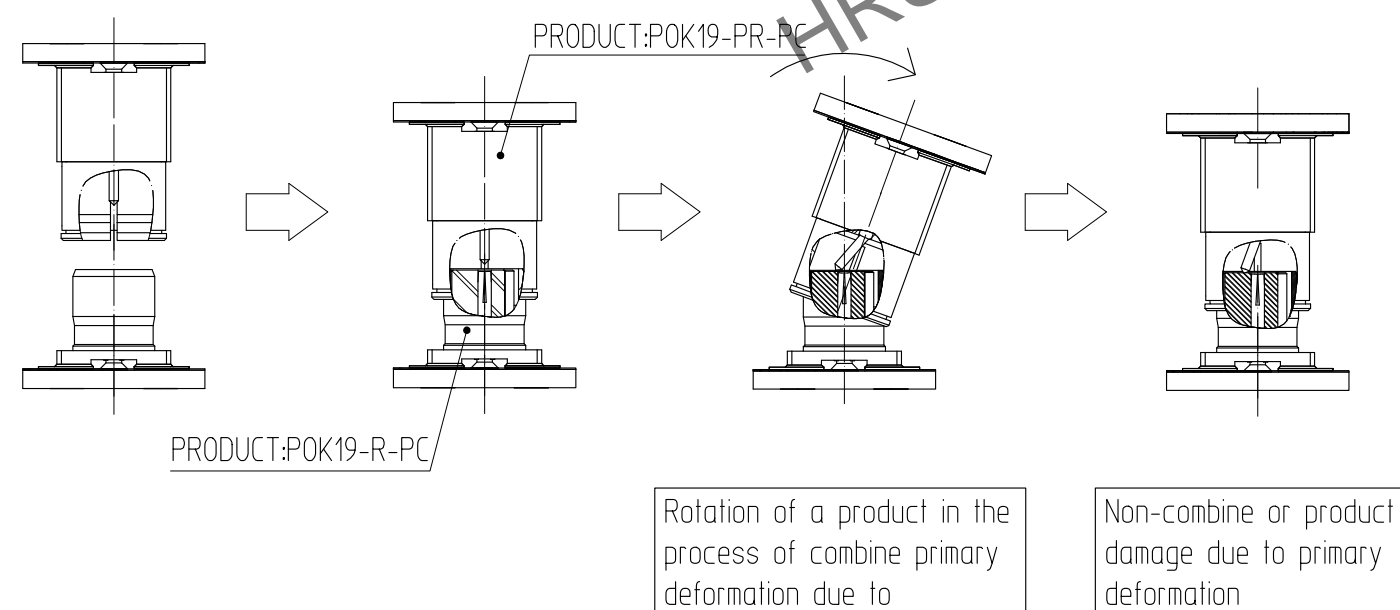

- ④ When using a combination of 'POK19-PR-PC' and 'POK19-R-PC',
It is recommended to use JIG separately to maintain the coupling against
external vibrations and shocks and to prevent move of the product.

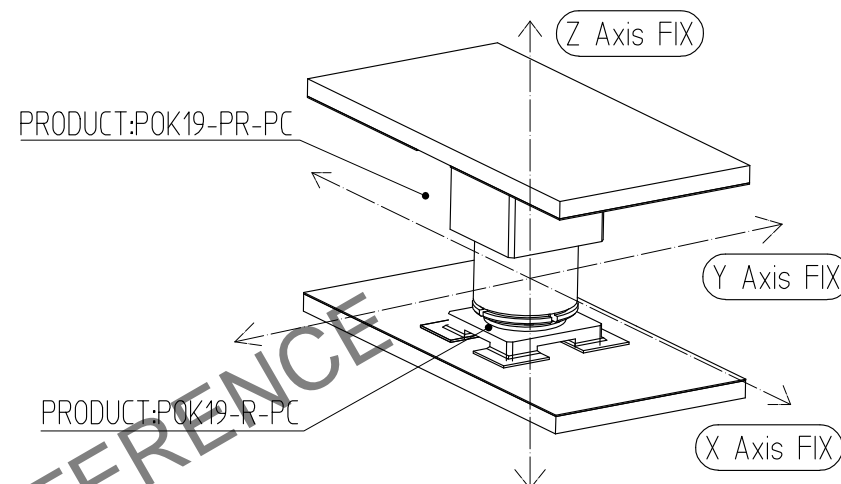

※Recommended method of coupling

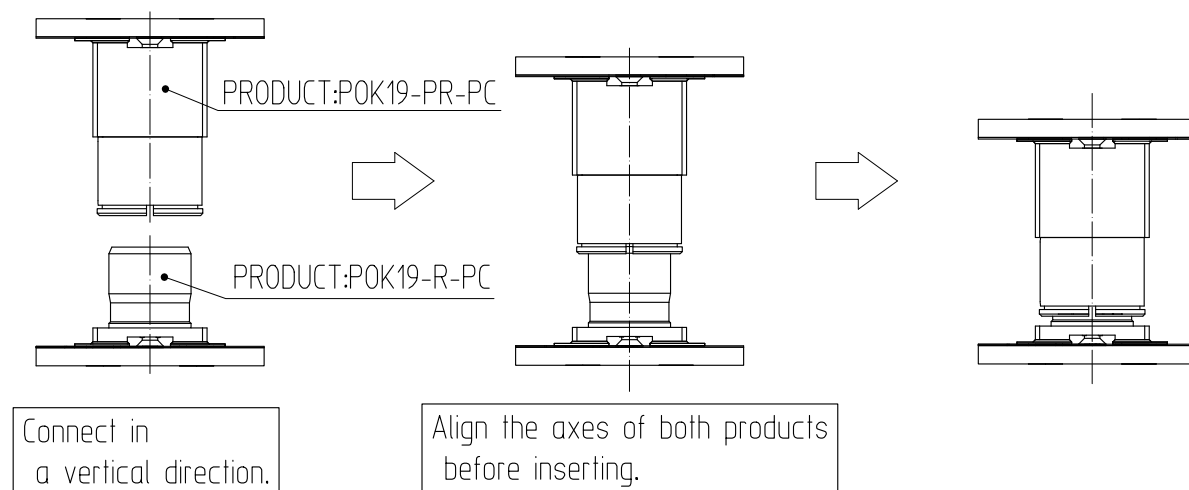

 SCALE 7:1 UNITS mm	DRAWING NO.	EDC3-633119	PART NO.	POK19-R-PC(895)
	HIROSE KOREA CO.,LTD.		CODE NO	CL 6341-0018-6-895

Jun.1.2024 Copyright 2024 HIROSE ELECTRIC CO., LTD. All Rights Reserved.
In case of consideration for using Automotive equipment / device which demand high reliability, kindly contact our sales window correspondents.

2. POK19-LP-1.5D ※Handling notice

① Note the contact deformation of 'POK19-LP-1.5D' due to external objects.

When contact is deformed and 'POK19-R-PC' is combined by contact deformation
It can be a cause lose of function /not be combined/product damage
(Including counterparties).

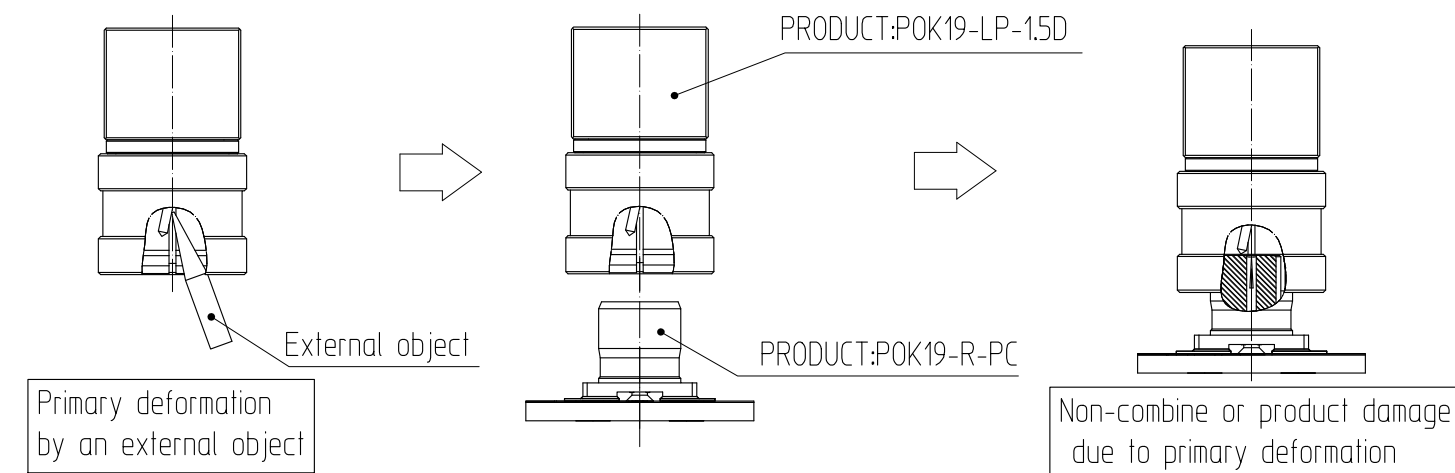

② When 'POK19-LP-1.5D' and 'POK19-R-PC' combine, there shall be no rotation.

If the rotation of 'POK19-LP-1.5D' or 'POK19-R-PC' occurs in the process of coupling,
contact is deformed. Contact deformation can be a cause lose of function/
not be combined/product damage (Including counterparties).

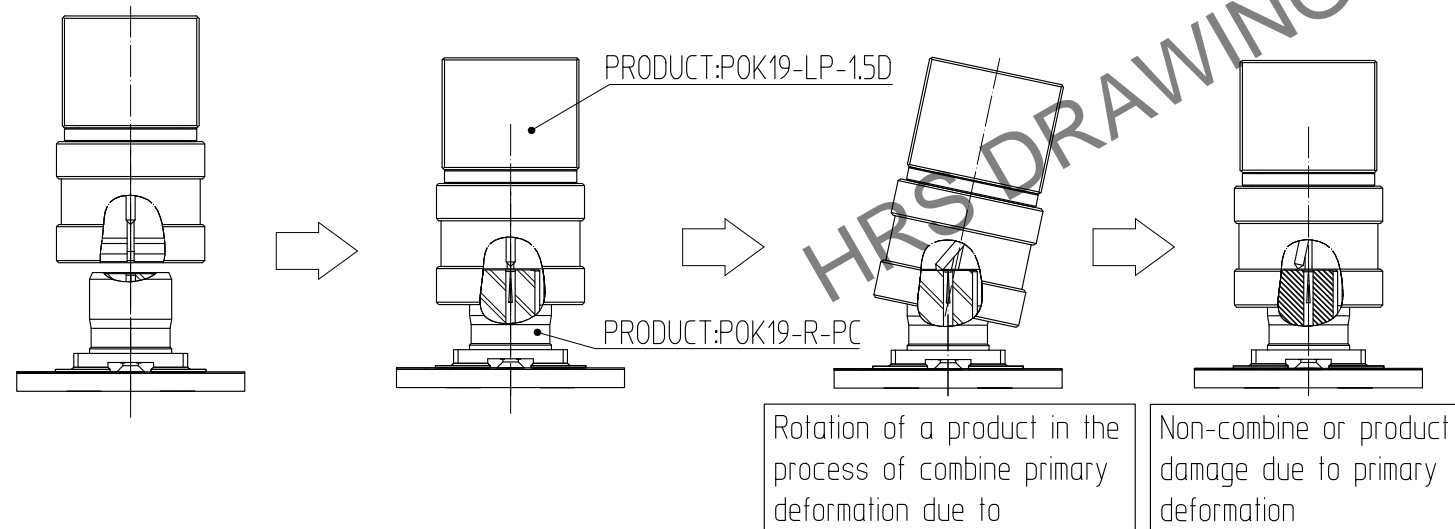

③ When handling two or more 'POK19-LP-1.5D', be careful of contact deformation
due to interference.

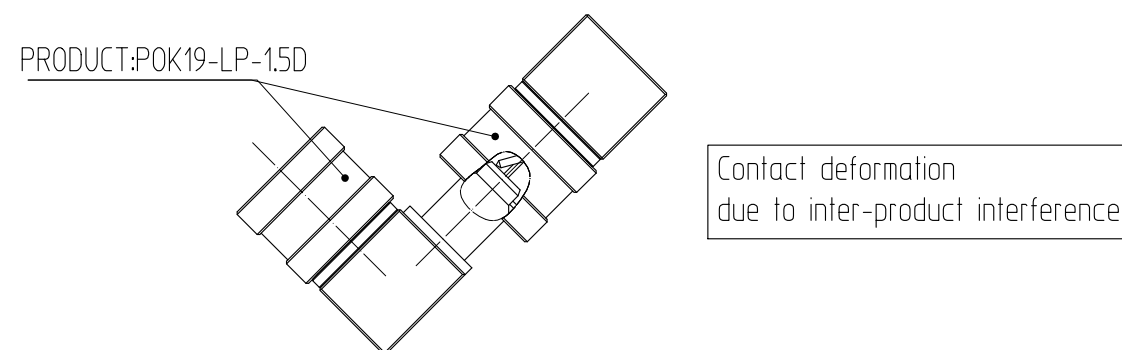

④ When using a combination of 'POK19-LP-1.5D' and 'POK19-R-PC',
It is recommended to use JIG separately to maintain the coupling against
external vibrations and shocks and to prevent move of the product.

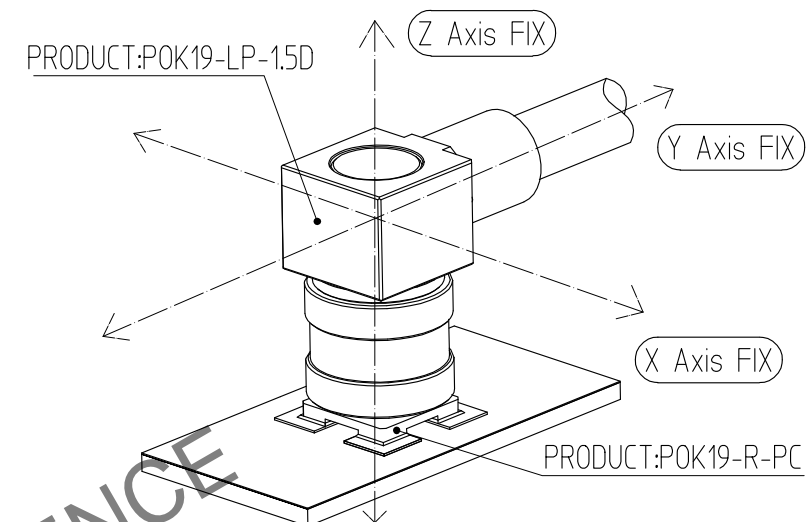

※Recommended method of coupling

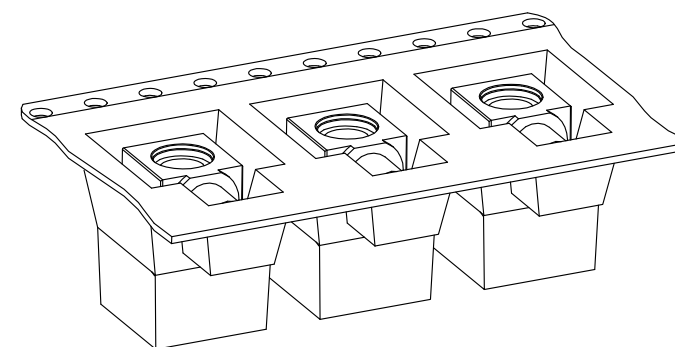
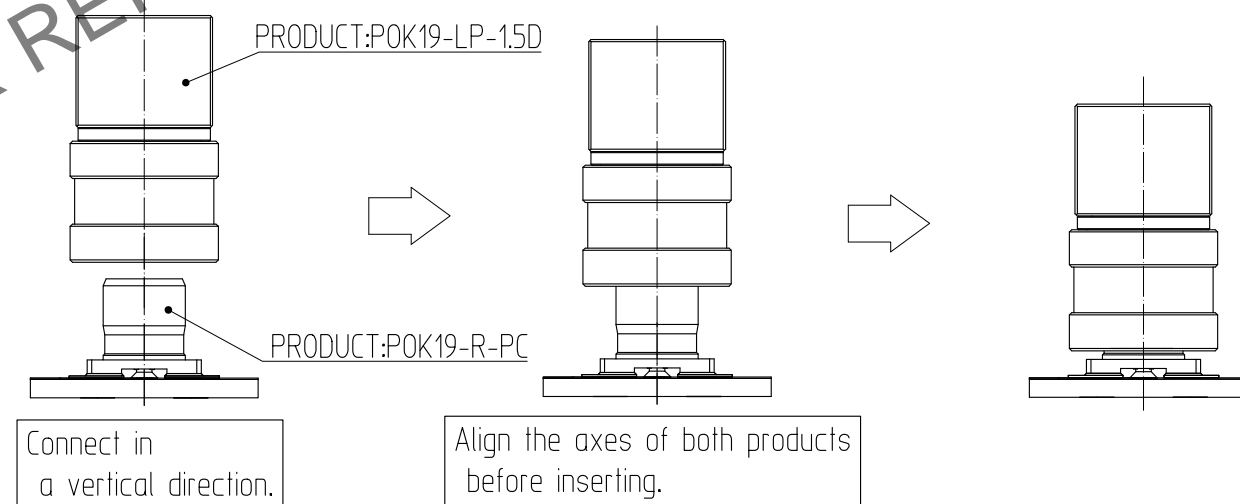

When not using the 'POK19-LP-1.5D' product,
it is recommended that it be stored packaged
to prevent product deformation.

SCALE 7:1 UNITS mm	DRAWING NO.	EDC3-633119	PART NO.	POK19-R-PC(895)	3 3
	HIROSE KOREA CO.,LTD.		CODE NO	CL 6341-0018-6-895	