

Mar.1.2025 Copyright 2025 HIROSE ELECTRIC CO., LTD. All Rights Reserved.
In case of consideration for using Automotive equipment / device which demand high reliability, kindly contact our sales window correspondents.

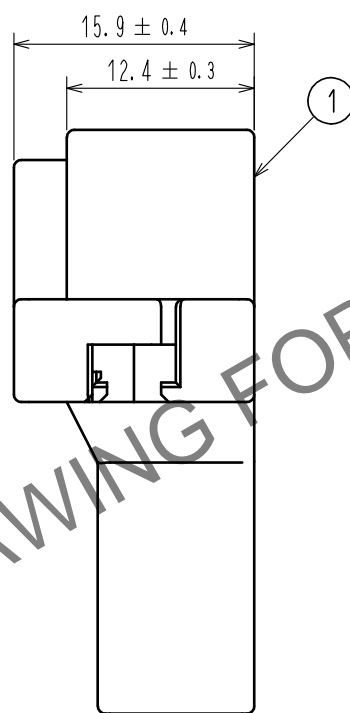

Recommended panel cut out dimension

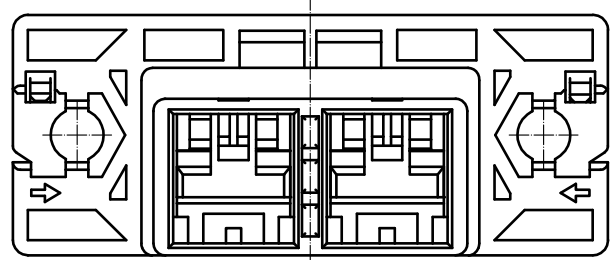
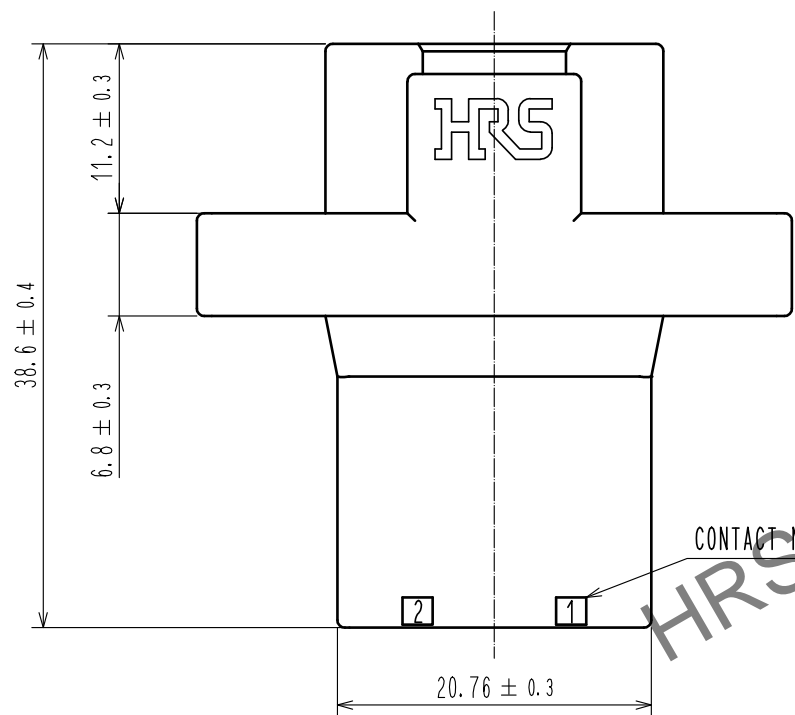
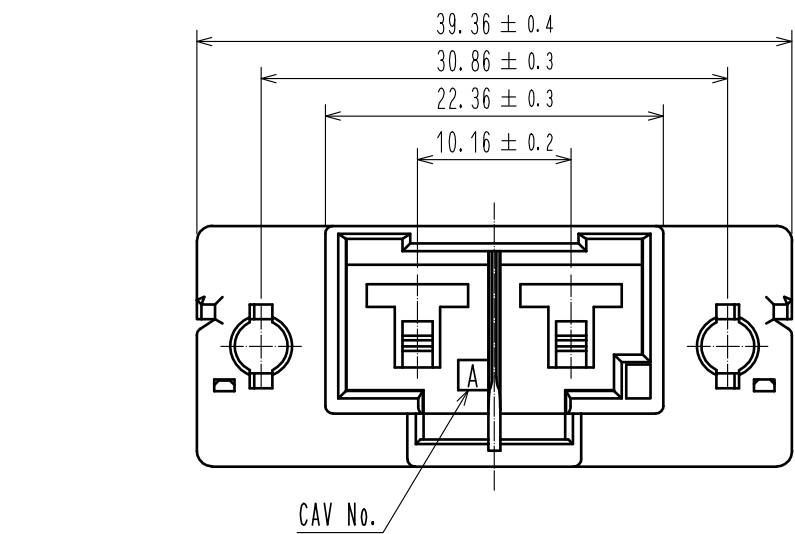
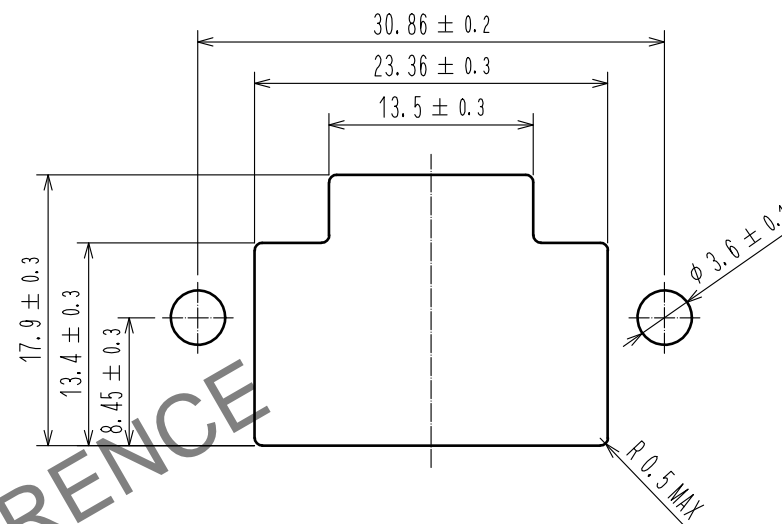

Mating figure

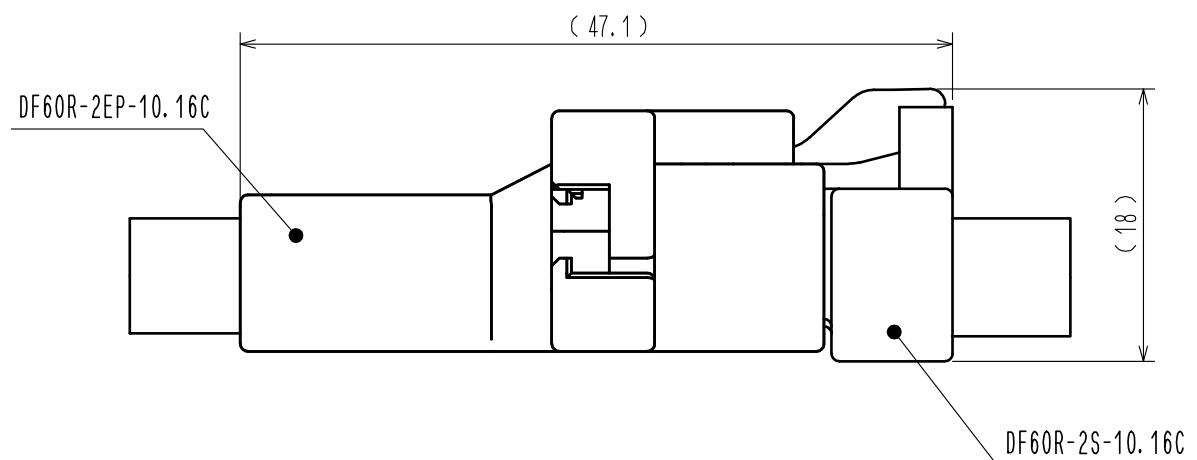

- Note 1. Per Pack : 100 Pieces
 2. UL(File No. E52653)
 C-UL(File No. E52653)
 TUV (Certificate No. R50244085) authorization article.



NO.	MATERIAL	FINISH . REMARKS	NO.	MATERIAL	FINISH . REMARKS		
			1	PBT	Gray . UL94V-0		
UNITS	mm	SCALE	COUNT	DESCRIPTION OF REVISIONS	DESIGNED	CHECKED	DATE
		2 : 1	△				
APPROVED : KI. AKIYAMA			15.07.06	DRAWING NO. EDC-363801-00-00			
CHECKED : TS. FUKUSHIMA			15.07.03	PART NO. DF60R-2EP-10.16C			
DESIGNED : TS. KUMAZAWA			15.07.03	CODE NO. CL680-3053-0-00			
DRAWN : TS. KUMAZAWA			15.07.03	△ 1/2			

Mar.1.2025 Copyright 2025 HIROSE ELECTRIC CO., LTD. All Rights Reserved.
In case of consideration for using Automotive equipment / device which demand high reliability, kindly contact our sales window correspondents.

DF60 IN-LINE TYPE RECOMMENDED PANEL MOUNTING MANUAL (WHEN NUTS USES)

NUT INSTALLATION PROCESS

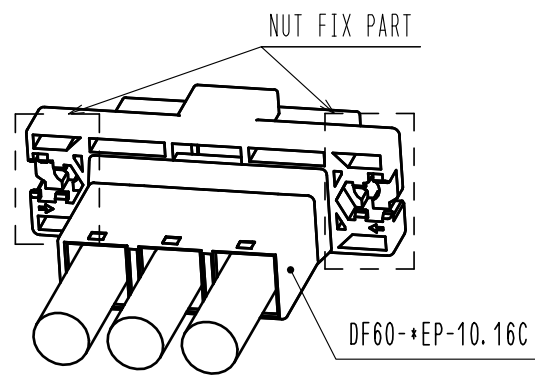

1. SLIDE A NUT (SIZE:M3) TO NUT FIX PART.

2. PRESS DOWN THE NUT UNTIL IT CLICKS,
THEN THIS SOUND MEANS THE NUT HAS INSERTED
INTO NUT HOLDER.

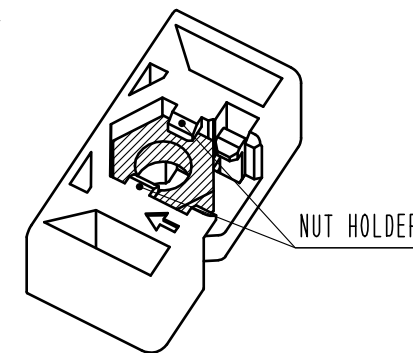
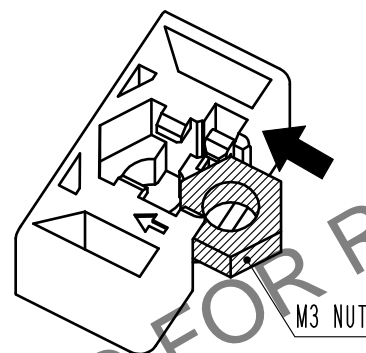

PANEL MOUNTING PROCESS

1. INSERT CONNECTOR INTO PANEL CUT OUT PART.

2. TIGHTEN A SCREW (SIZE:M3) TO FIX WITH PANEL.
RECOMMENDED TORQUE : LESS THAN 49N · cm

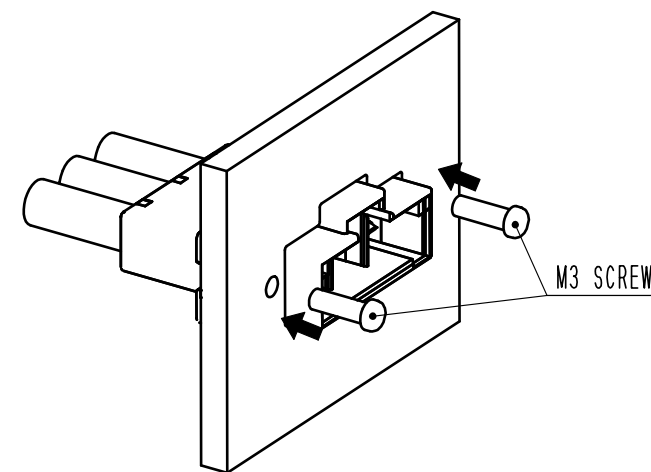
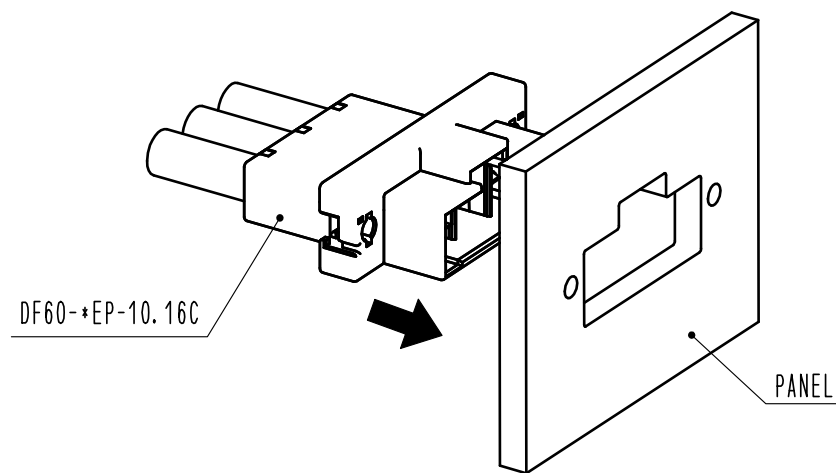

HRS	DRAWING NO.	EDC-363801-00-00
	PART NO.	DF60R-2EP-10.16C
	CODE NO.	CL680-3053-0-00
		2/2