

ELV. RoHS COMPLIANT

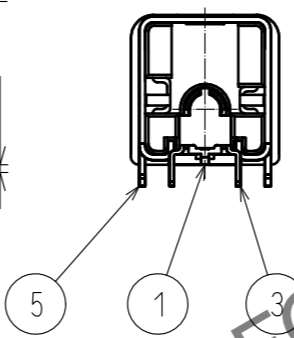

Recommended panel layout

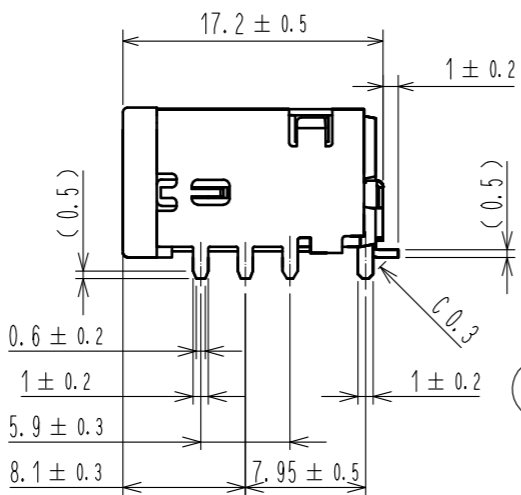
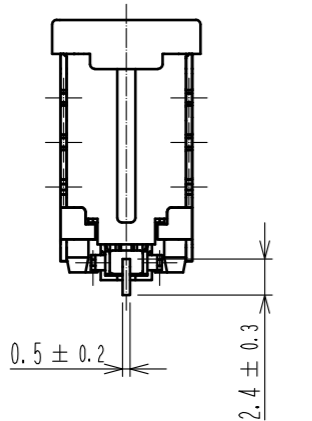
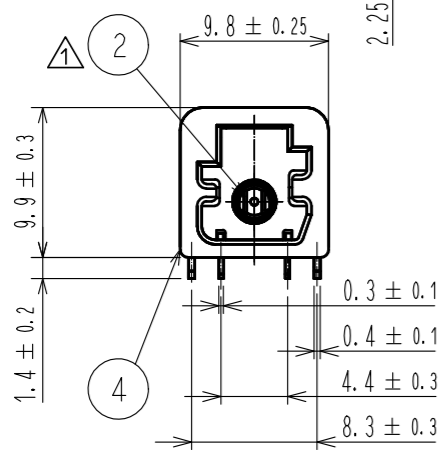
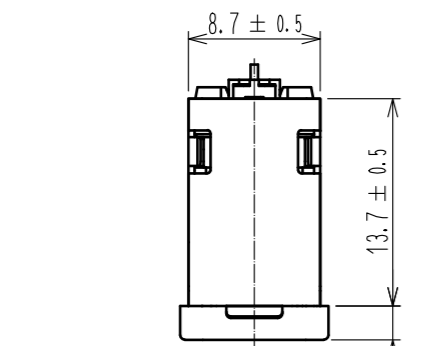
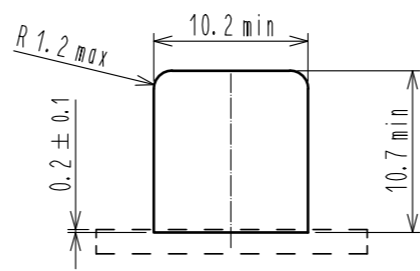

Recommended board pattern

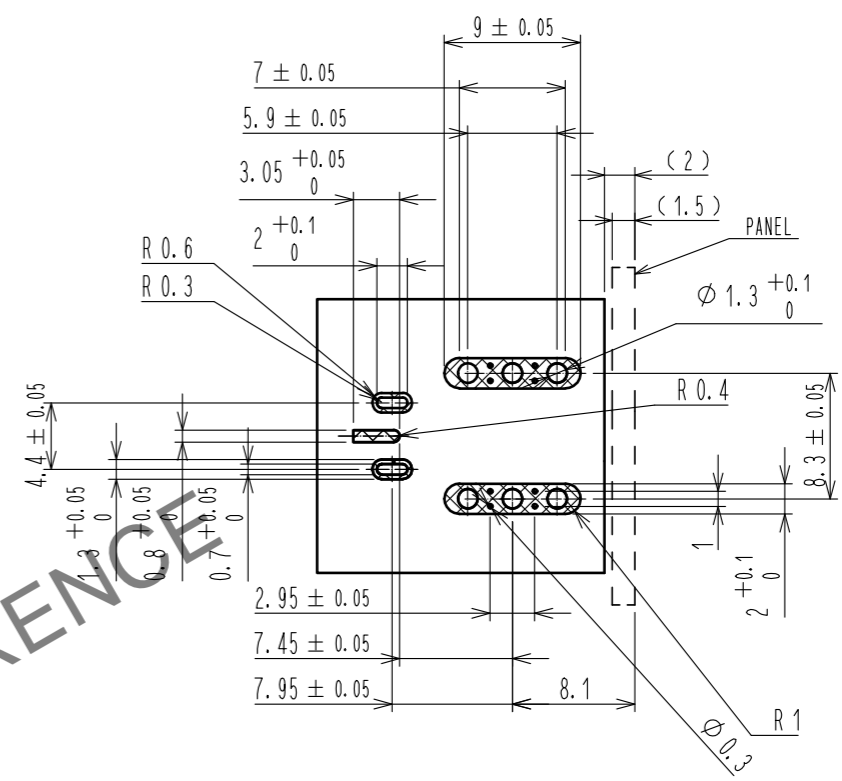

Mated connectors

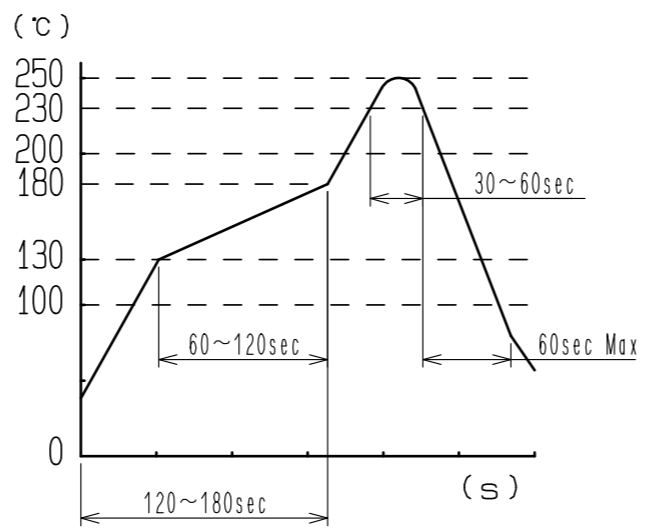
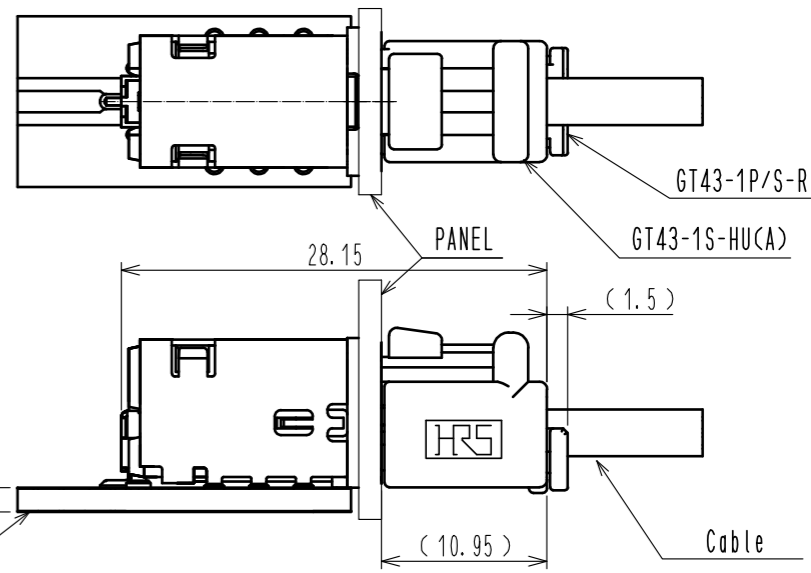

- NOTES
- Recommended reflow profile (See right graph)
 Cycle time : Twice
 Peak temperature : 250°C
 230°C MIN : 30~60s
 Preheating area : 130~180°C, 60~120s
 - Hand soldering : 280~300°C 2s Max
 - Recommended thickness of PCB : 1.6^{+0.2}mm
 - Recommended thickness of Solderling paste : 0.15mm

3	Brass	Tin plating				
2	PA	Black	5	Copper alloy	Tin plating	
1	Brass	Tin plating	4	PA	Brown	
NO.	MATERIAL	FINISH . REMARKS	NO.	MATERIAL	FINISH . REMARKS	
UNITS	mm	SCALE	2 : 1	COUNT	2	DESCRIPTION OF REVISIONS
						DESIGNED
						CHECKED
						DATE
						APPROVED : KI. HIROKAWA 17.06.30
						CHECKED : KI. HIROKAWA 17.06.30
						DESIGNED : NK. IKUTA 17.06.30
						DRAWN : GYEONGMIN LEE 17.06.30
DRAWING NO.			EDC-372980-00-00			
PART NO.			GT43-1P-H(A)			
CODE NO.			CL753-1001-0-00			
						1/2

Mar.1.2026 Copyright 2026 HIROSE ELECTRIC CO., LTD. All Rights Reserved. In case of consideration for using Automotive equipment / device which demand high reliability, kindly contact our sales window correspondents.

Mar.1.2026 Copyright 2026 HIROSE ELECTRIC CO., LTD. All Rights Reserved.
 In case of consideration for using Automotive equipment / device which demand high reliability, kindly contact our sales window correspondents.

tray A(1:2)

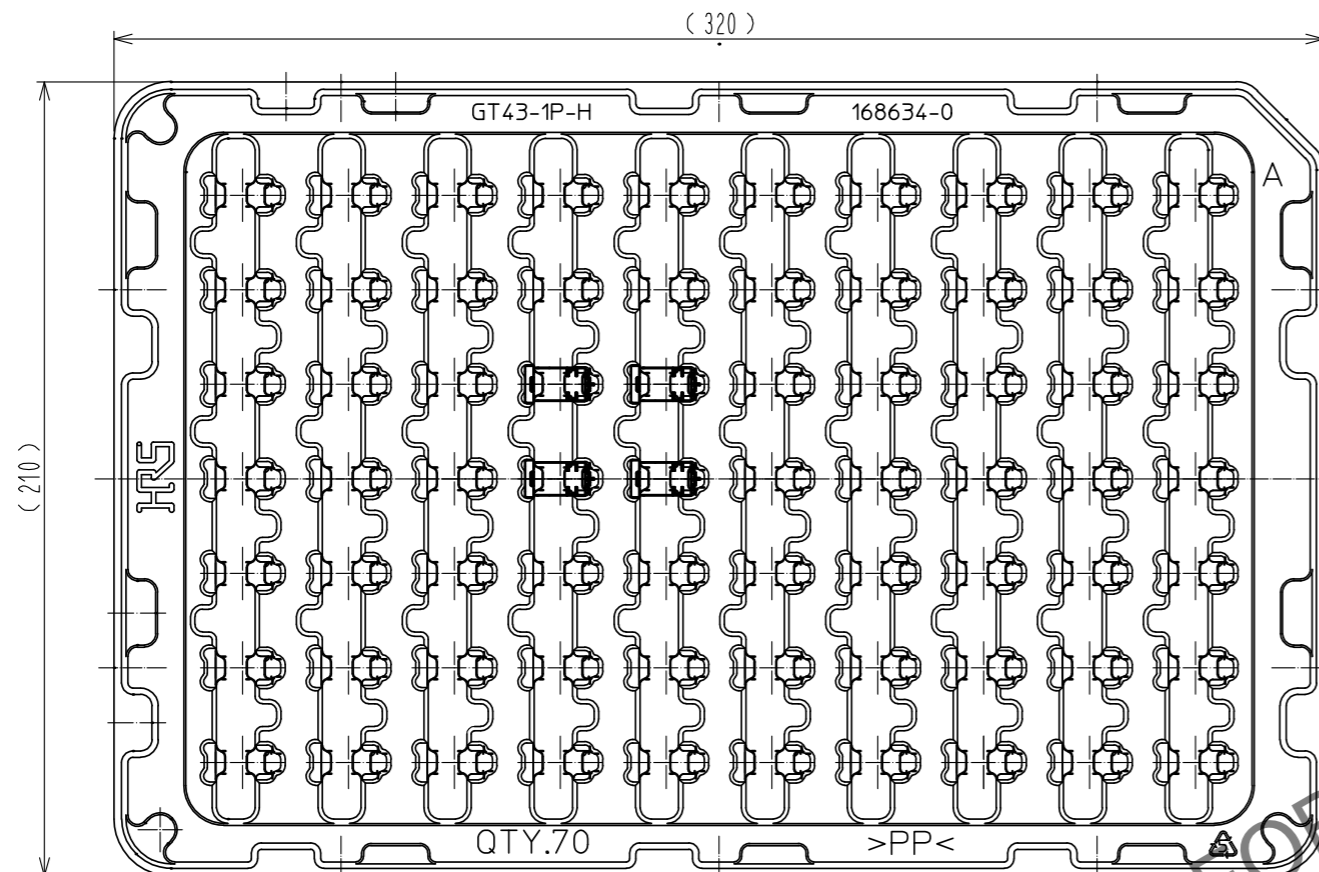

tray B(1:2)

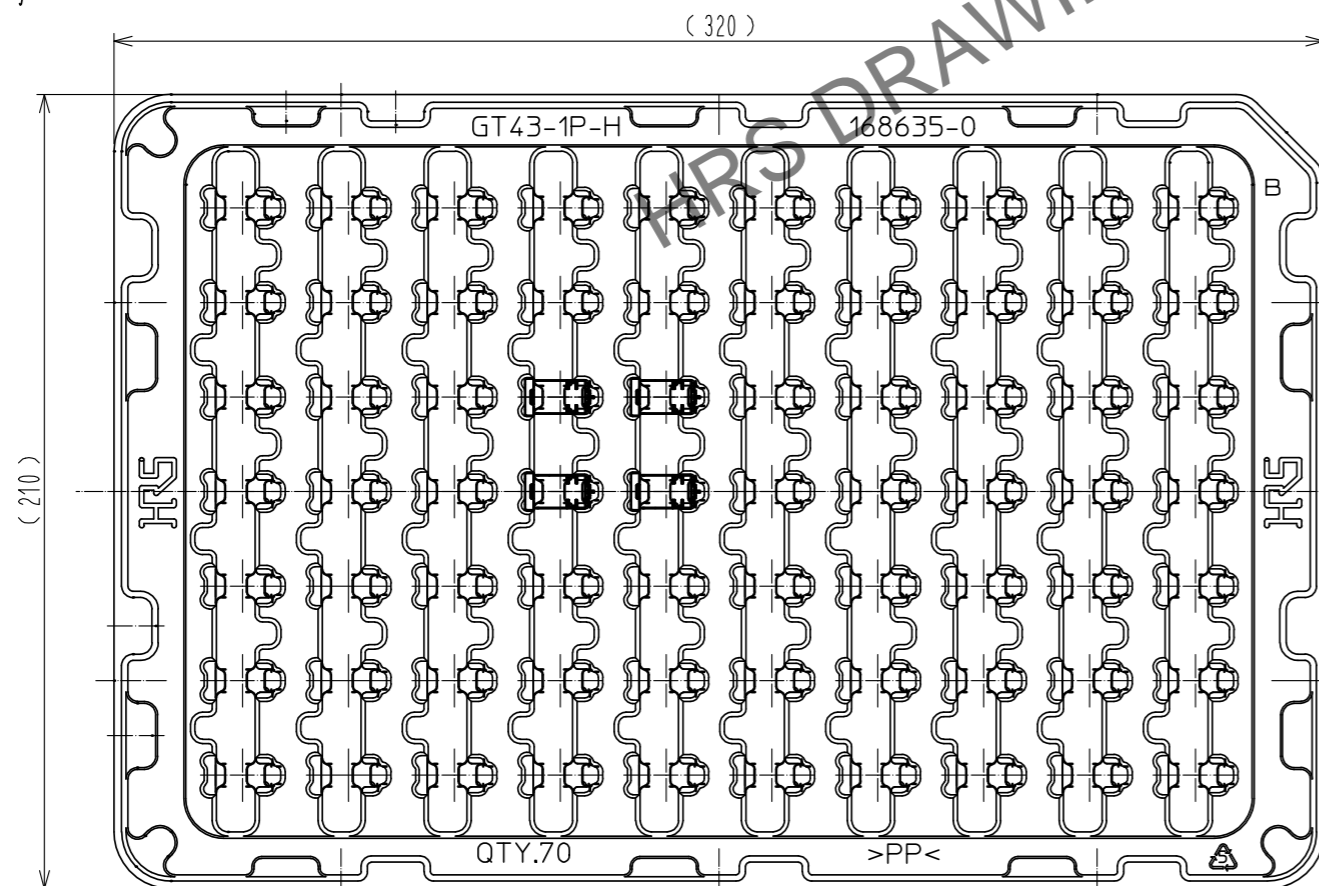

Packing style

- ① Put the connector on the tray A and tray B.
- ② Stack tray A and tray B staggered. Top tray is empty.
1tray : 70pcs
- ③ Put two sets of cardboard.
Cardboard : 700pcs

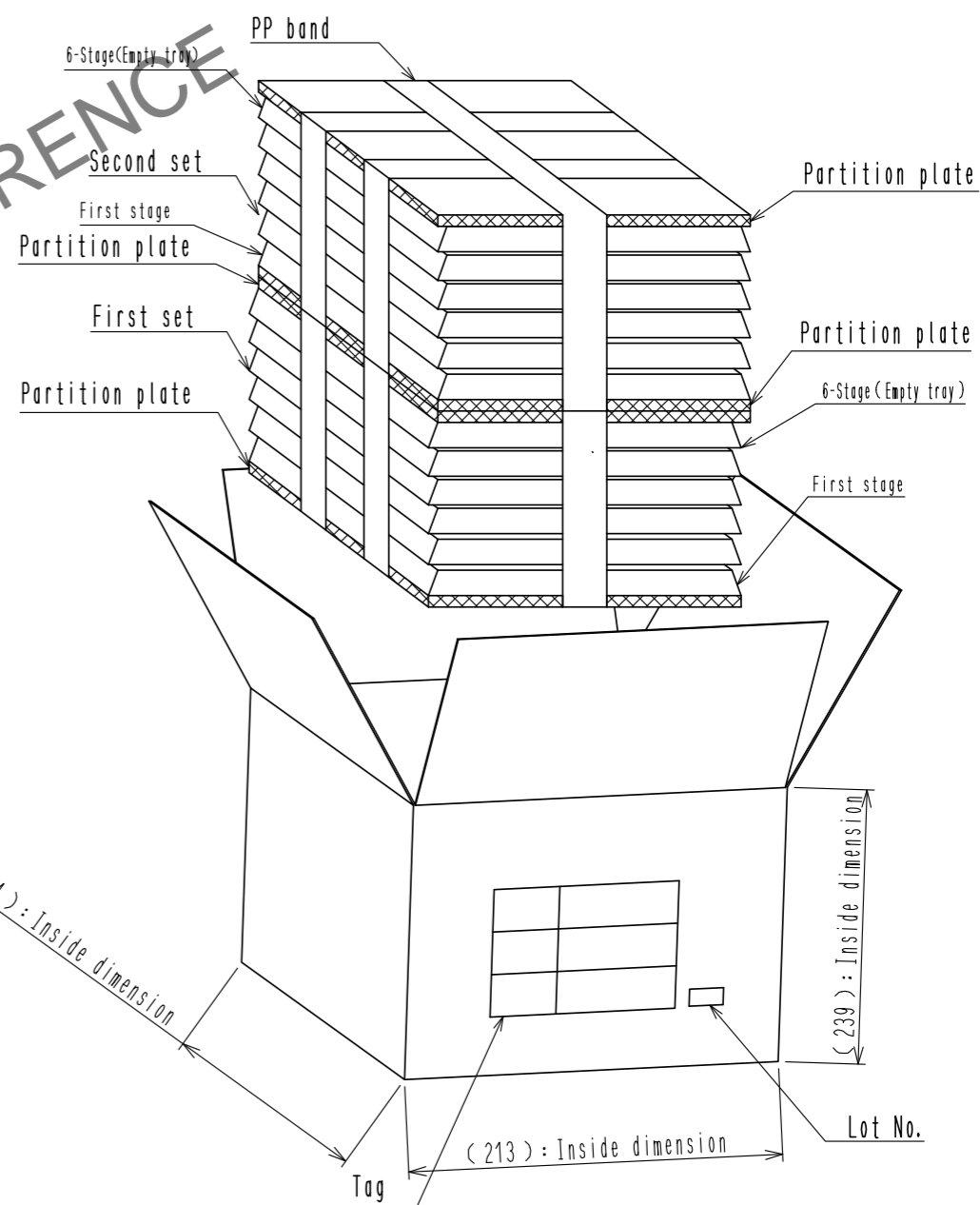

HRS	DRAWING NO.	EDC-372980-00-00	2/2
	PART NO.	GT43-1P-H(A)	
	CODE NO.	CL753-1001-0-00	
	△		