

Apr.1.2026 Copyright 2026 HIROSE ELECTRIC CO., LTD. All Rights Reserved.
In case of consideration for using Automotive equipment / device which demand high reliability, kindly contact our sales window correspondents.

ELV. RoHS COMPLIANT

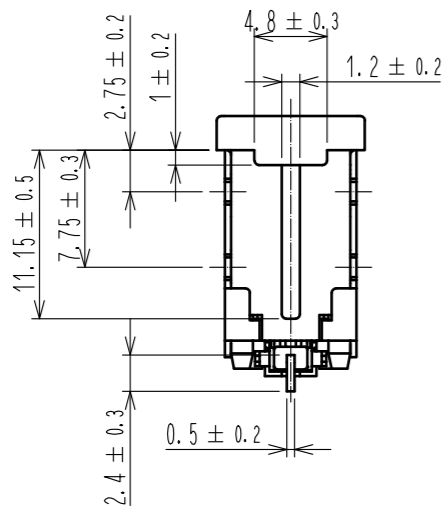
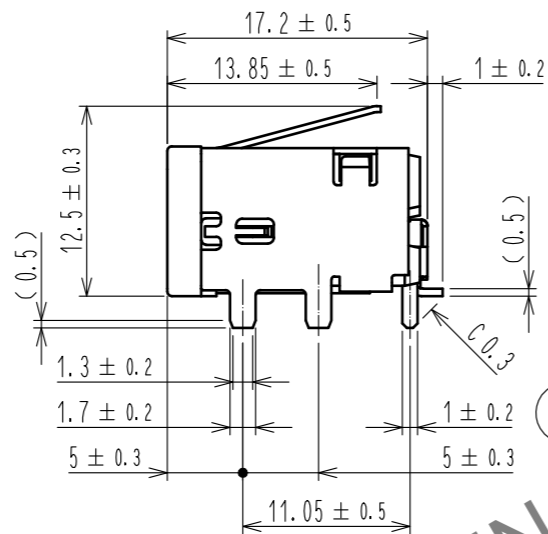
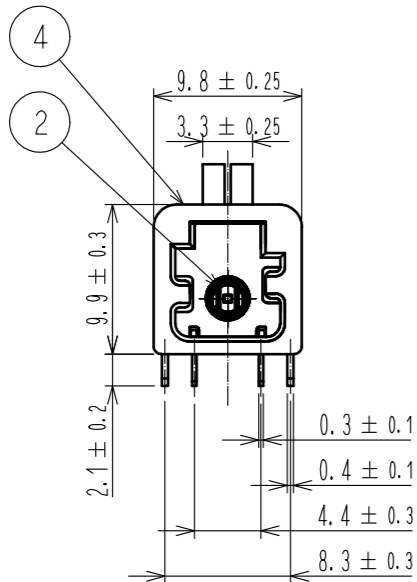
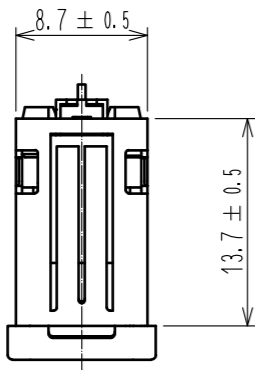

HRS DRAWING FOR REFERENCE

RECOMMENDED PC BOARD PATTERN

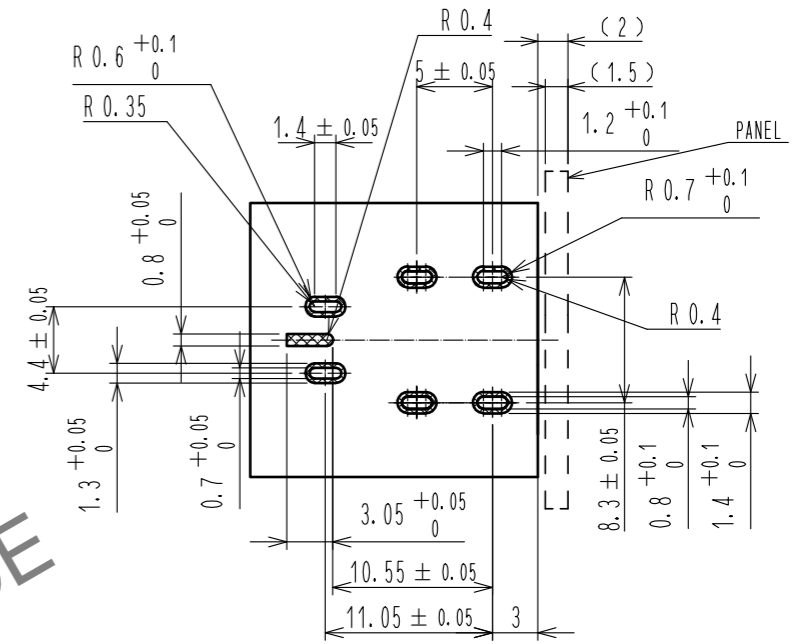

RECOMMENDED PANEL LAYOUT

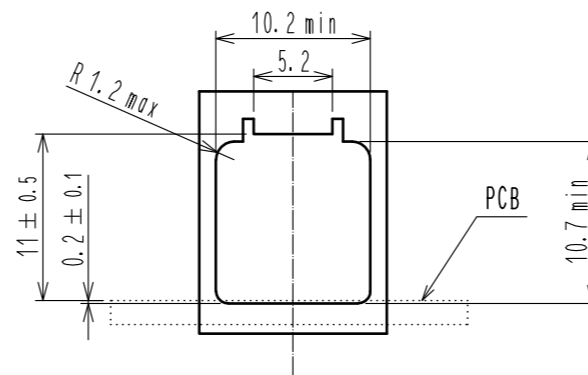

MATED CONNECTORS

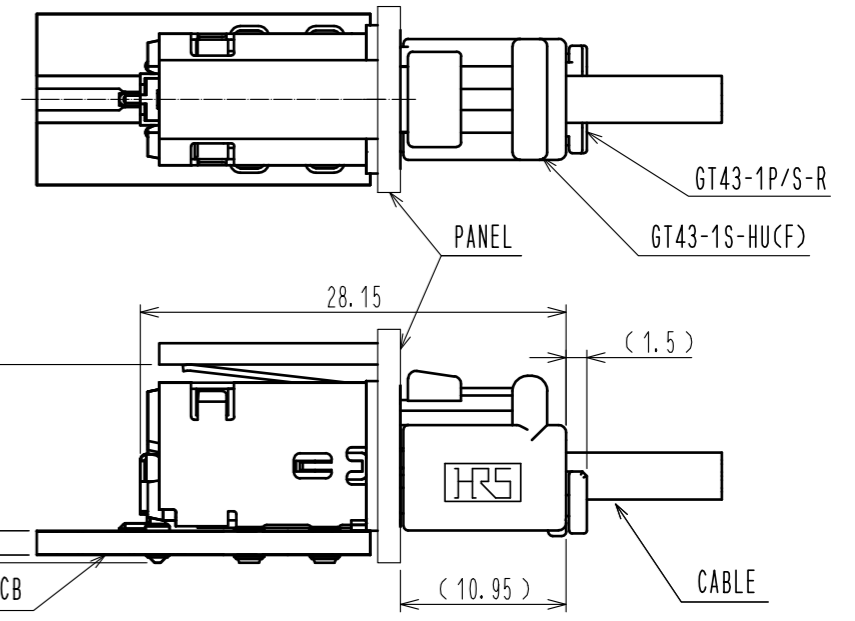

NOTES

- RECOMMENDED TEMPERATURE PROFILE FOR REFLOW (REFER TO RIGHT FIG.)
NO. OF CYCLES : 2
PEAK : 250°C
OVER 230°C : 30~60s
PREHEAT : 130~180°C, 60~120s
- TEMPERATURE FOR SOLDERING IRON: 280~300°C WITHIN 2s
- RECOMMENDED PCB THICKNESS : 1.6 ^{+0.2} mm
- RECOMMENDED THICKNESS OF SOLDERING PASTE : 0.15mm

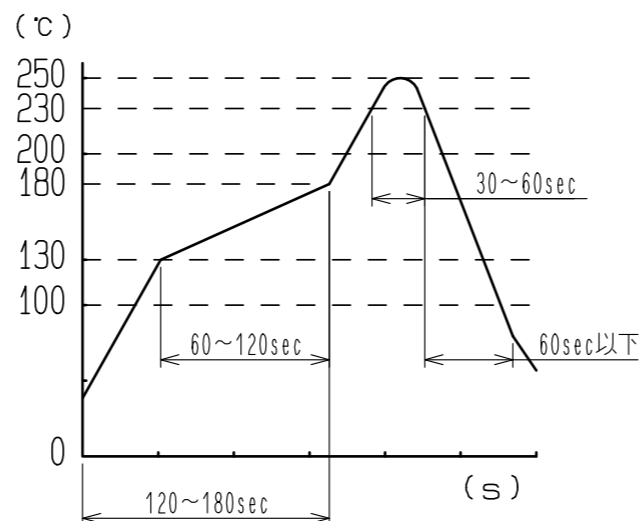

NO.	MATERIAL	FINISH . REMARKS	NO.	MATERIAL	FINISH . REMARKS
3	BRASS	TIN PLATING	5	COPPER ALLOY	TIN PLATING
2	PA	BLACK	4	PA	PURPLE
1	BRASS	TIN PLATING			

UNITS	SCALE	COUNT	DESCRIPTION OF REVISIONS	DESIGNED	CHECKED	DATE
mm	2 : 1	1	DIS-T-00003144	NK. IKUTA	KI. HIROKAWA	18.04.05

APPROVED	CHECKED	DESIGNED	DRAWN	DRAWING NO.	PART NO.	CODE NO.
KI. HIROKAWA	KI. HIROKAWA	NK. IKUTA	DS. HIROWATARI	EDC-377155-00-00	GT43D-1P-HCF)	CL753-1018-0-00