

Mar.1.2026 Copyright 2026 HIROSE ELECTRIC CO., LTD. All Rights Reserved.
 In case of consideration for using Automotive equipment / device which demand high reliability, kindly contact our sales window correspondents.

ELV. RoHS COMPLIANT

Recommended board pattern

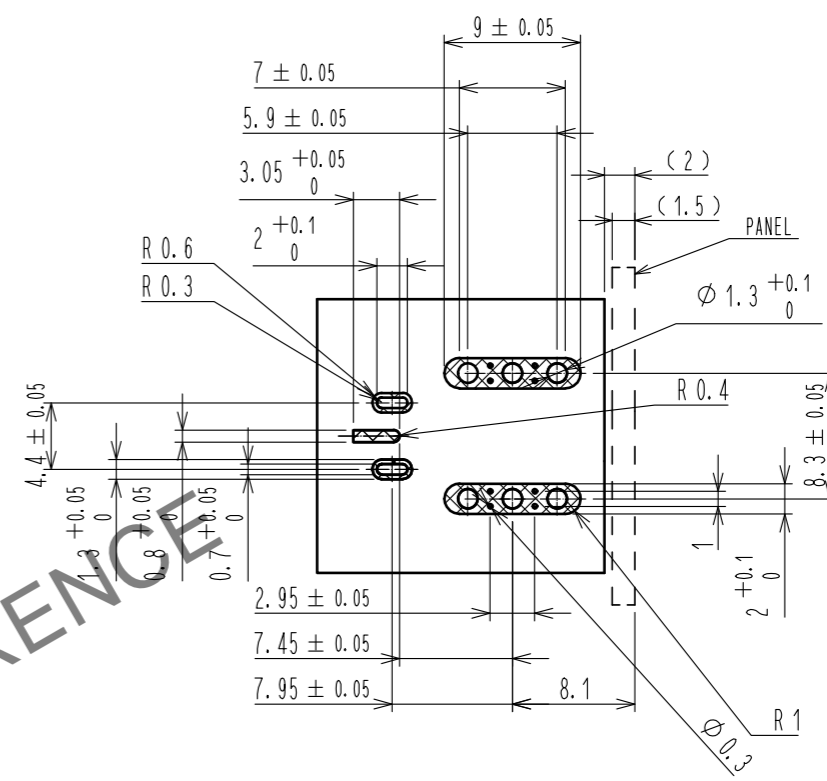
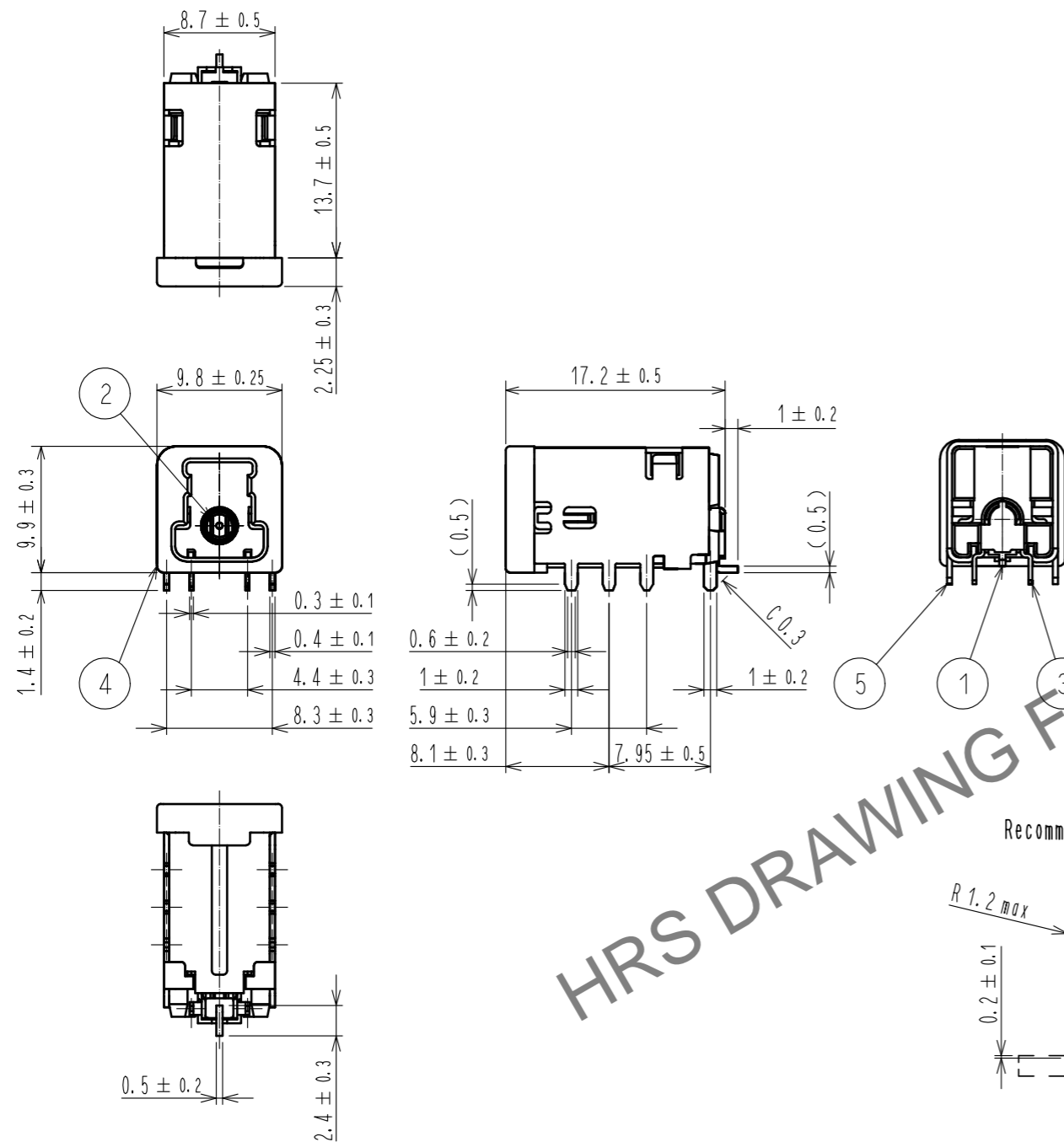

Mated connectors

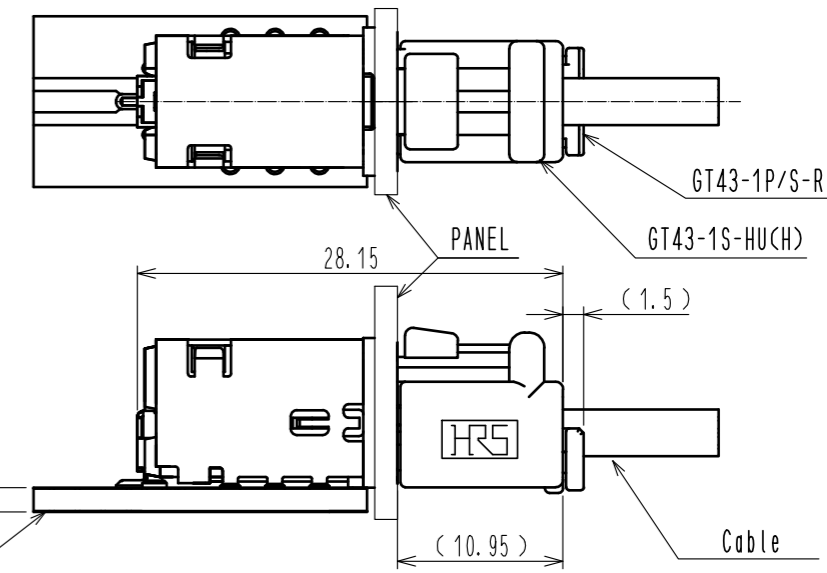

Recommended panel layout

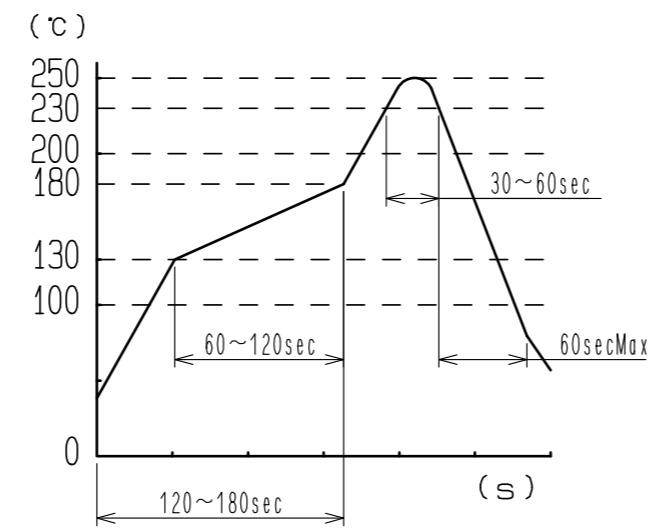
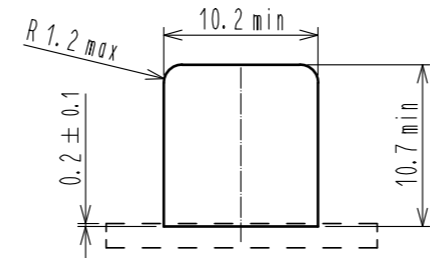

NOTES

1. Recommended reflow profile (See right graph)
 Cycle time : Twice
 Peak temperature : 250°C
 230°C MIN : 30~60s
 Preheating area : 130~180°C. 60~120s
2. Hand soldering : 280~300°C 2s Max
3. Recommended thickness of PCB : 1.6^{+0.2}mm
4. Recommended thickness of Solderling paste : 0.15mm

3	Brass	Tin plating			
2	PA	Black	5	Copper alloy	Tin plating
1	Brass	Tin plating	4	PA	Curry
NO.	MATERIAL	FINISH . REMARKS	NO.	MATERIAL	FINISH . REMARKS
UNITS	mm	SCALE	2 : 1	COUNT	DESCRIPTION OF REVISIONS
					DESIGNED
					CHECKED
					DATE
APPROVED : KI. HIROKAWA			20210317	DRAWING NO. EDC-387429-00-00	
CHECKED : MO. OKADA			20210317	PART NO. GT43-1P-H(CH)	
DESIGNED : KN. MIKAMI			20210317	CODE NO. CL0753-1025-0-00	
DRAWN : KN. MIKAMI			20210317		

Mar.1.2026 Copyright 2026 HIROSE ELECTRIC CO., LTD. All Rights Reserved.
 In case of consideration for using Automotive equipment / device which demand high reliability, kindly contact our sales window correspondents.

tray A(1:2)

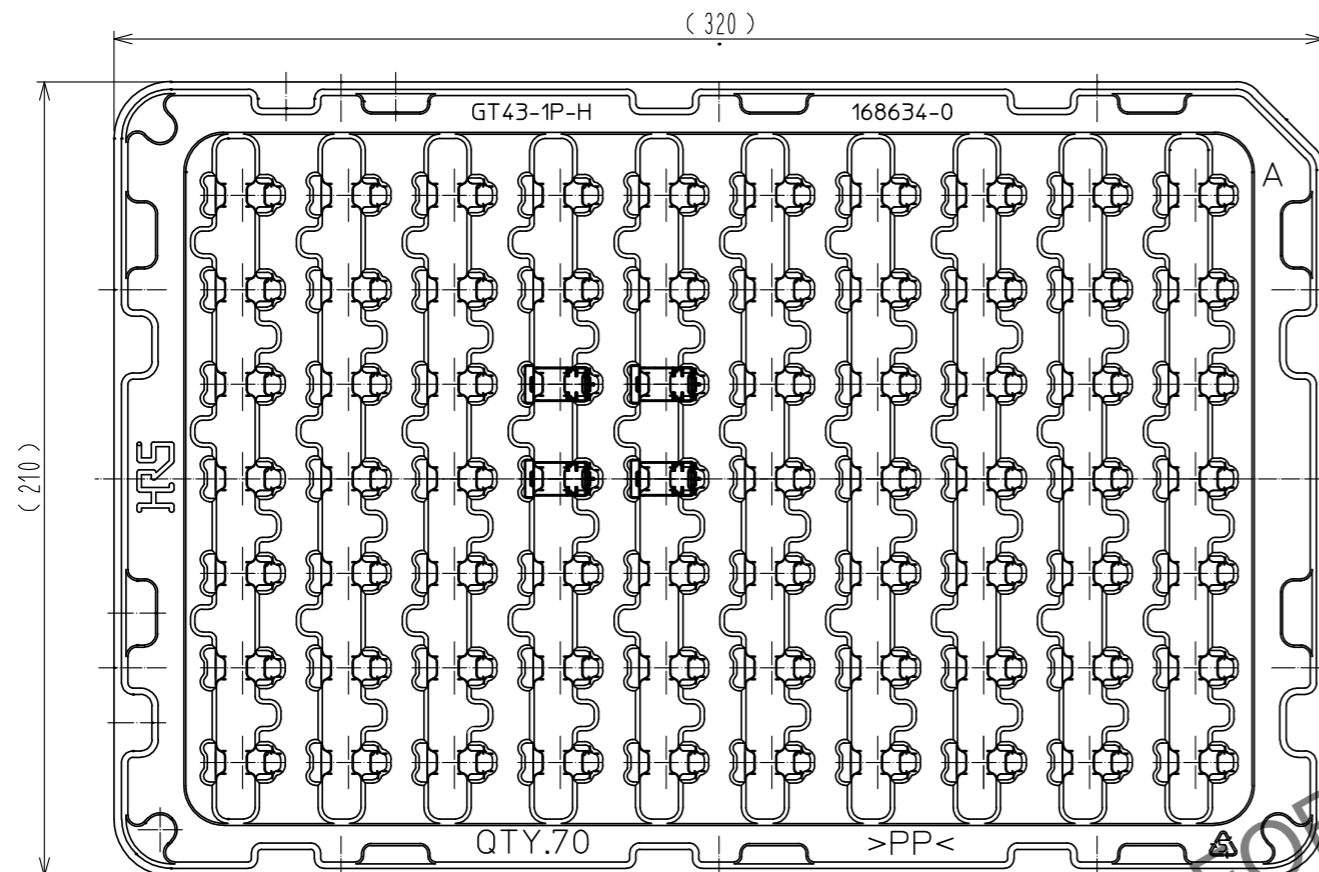

tray B(1:2)

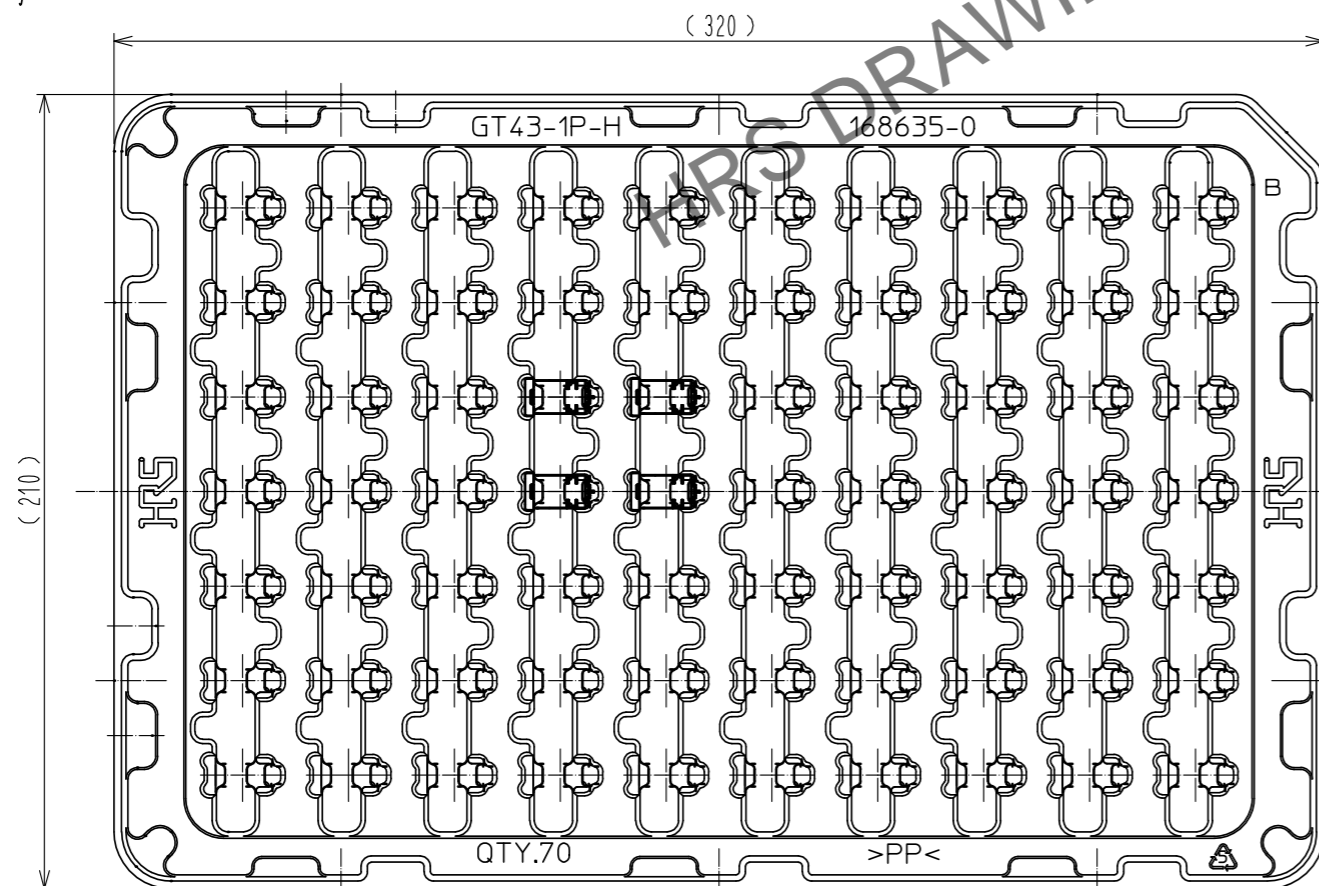

Packing style

- ① Put the connector on the tray A and tray B.
- ② Stack tray A and tray B staggered. Top tray is empty.
1tray : 70pcs
- ③ Put two sets of cardboard.
Cardboard : 700pcs

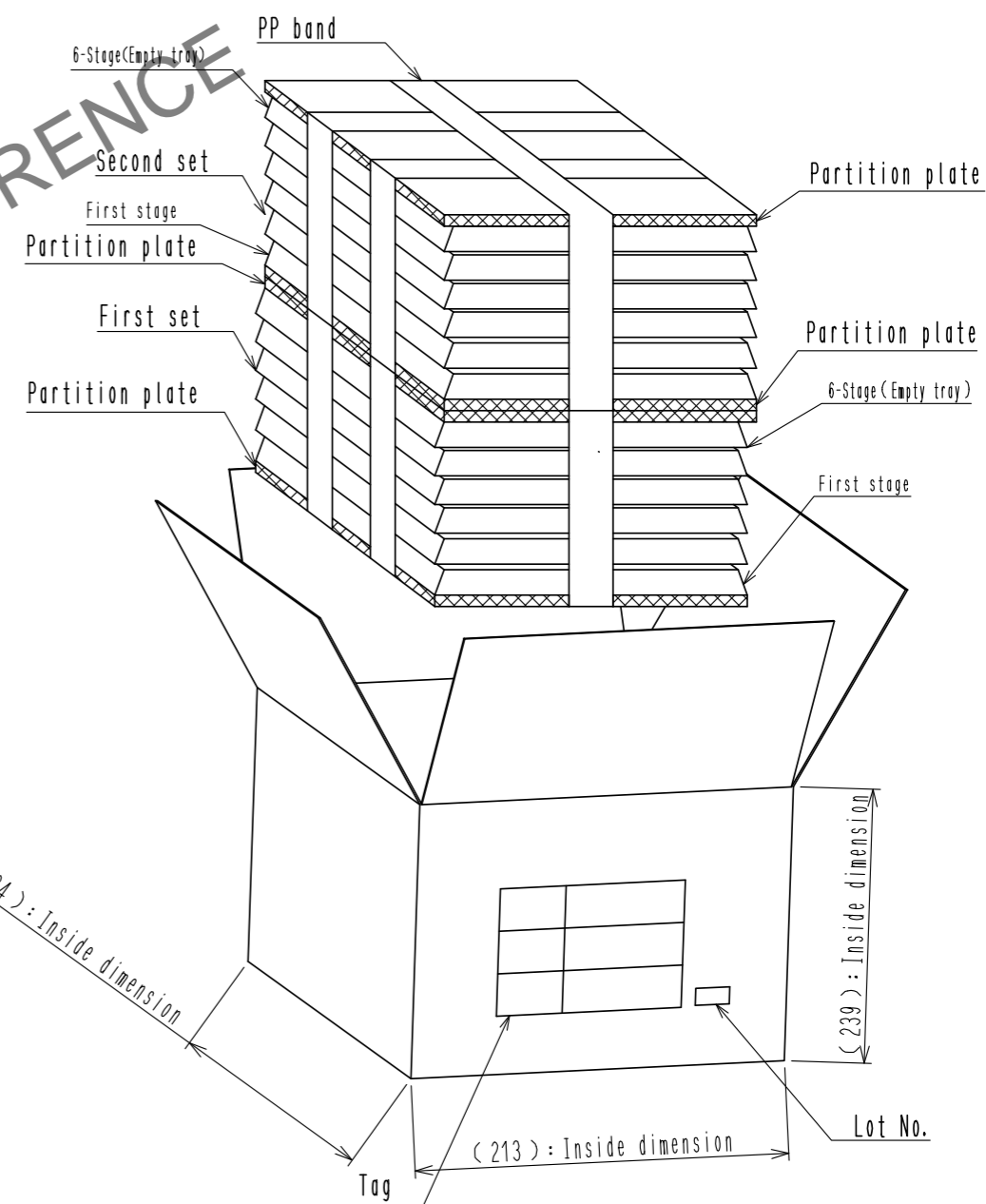

HRS	DRAWING NO.	EDC-387429-00-00
	PART NO.	GT43-1P-H(CH)
	CODE NO.	CL0753-1025-0-00
		2/2